

$V = 50 \text{ m.p.h.}$
 $R = 1179.78 \quad L = 514.06$
 $A.O. = 519.96 \quad A.X. = 38.13$
 $S.E. = 1''/ft. \quad E.W. = 2''/ft.$

$D = 18^\circ \quad V = 55 \text{ m.p.h.}$
 $R = 1602.93 \quad L = 503.21$
 $A.O. = 506.13 \quad A.X. = 26.63$
 $E.W. = 2''/ft. \quad S.E. = 1''/ft.$

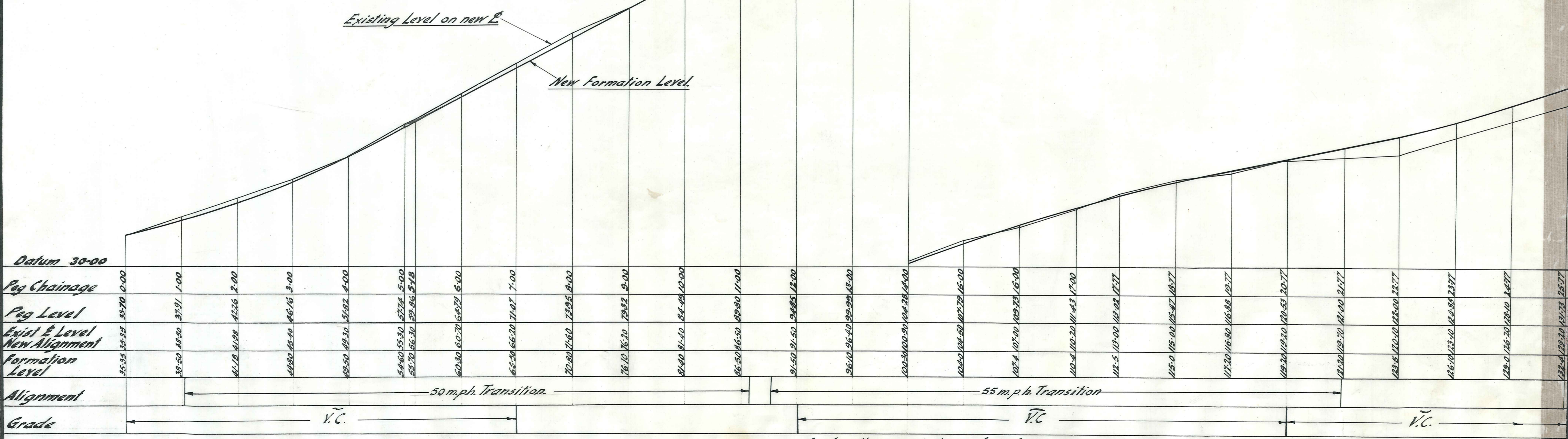
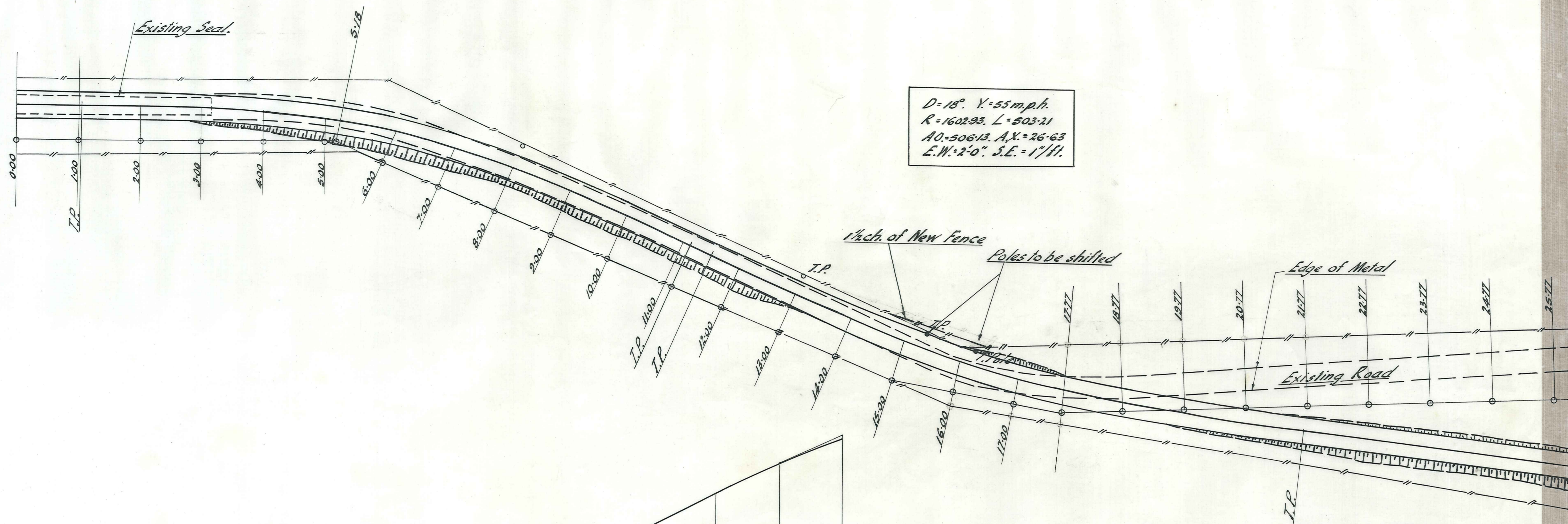

Scale: Horizontal, 1 inch = 100 ft.
Vertical, 1 inch = 10 ft.

VINCENT COUNTY COUNCIL	BLACKS HILL RD. RECONSTRUCTION 0+00. ~ 25+77. CHAINS.	DUFFILL, WATTS & KING CONSULTING CIVIL & STRUCTURAL ENGINEERS DUNEDIN and INVERCARGILL	<table border="1"> <tr><th>NAME</th><th>DATE</th></tr> <tr><td>Checked by: G. J. Dillon</td><td>Oct. 1964</td></tr> <tr><td>Calculated by:</td><td>.....</td></tr> <tr><td>Checked by: R. J. Woodman</td><td>Oct. 1964</td></tr> <tr><td>Traced by:</td><td>.....</td></tr> <tr><td>Approved by:</td><td>.....</td></tr> </table>	NAME	DATE	Checked by: G. J. Dillon	Oct. 1964	Calculated by:	Checked by: R. J. Woodman	Oct. 1964	Traced by:	Approved by:	JOB No. 4463/1 F.B.K. 195 FILE No. 447
			NAME	DATE												
Checked by: G. J. Dillon	Oct. 1964															
Calculated by:															
Checked by: R. J. Woodman	Oct. 1964															
Traced by:															
Approved by:															

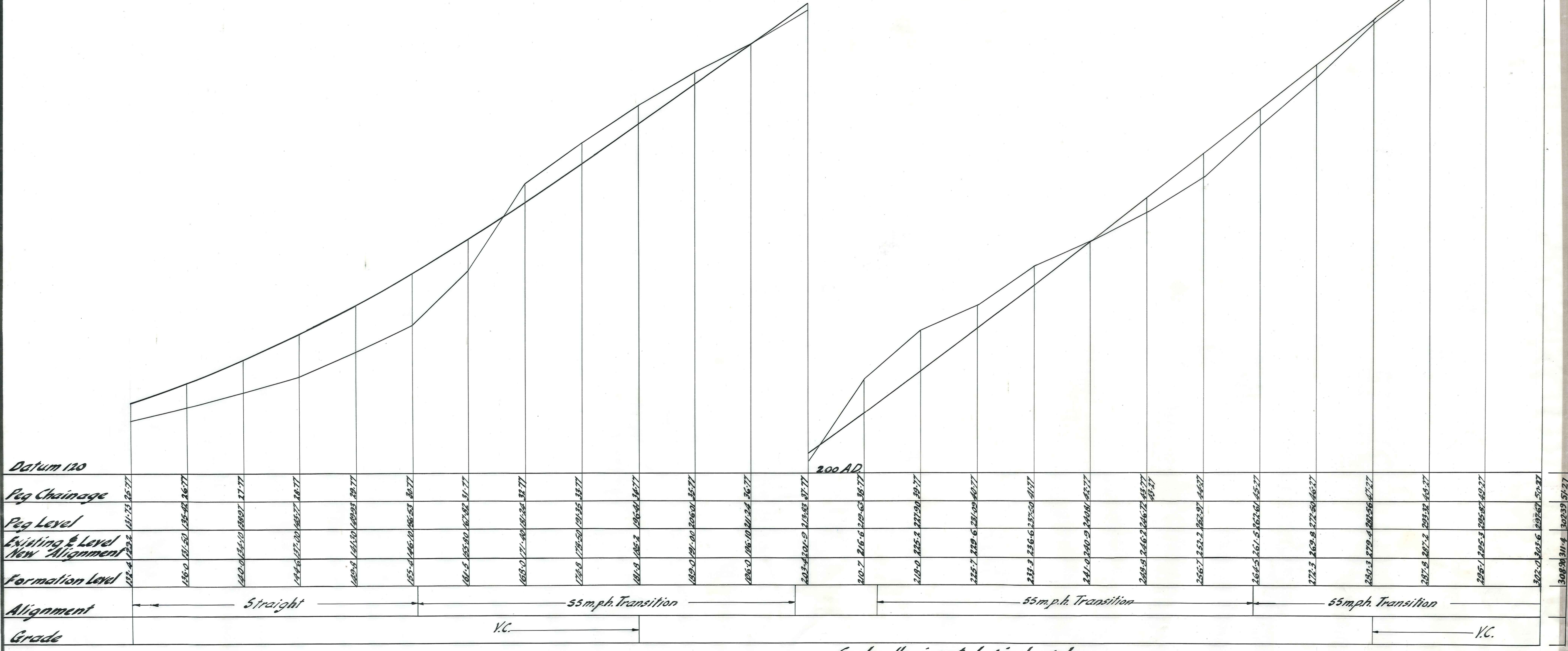
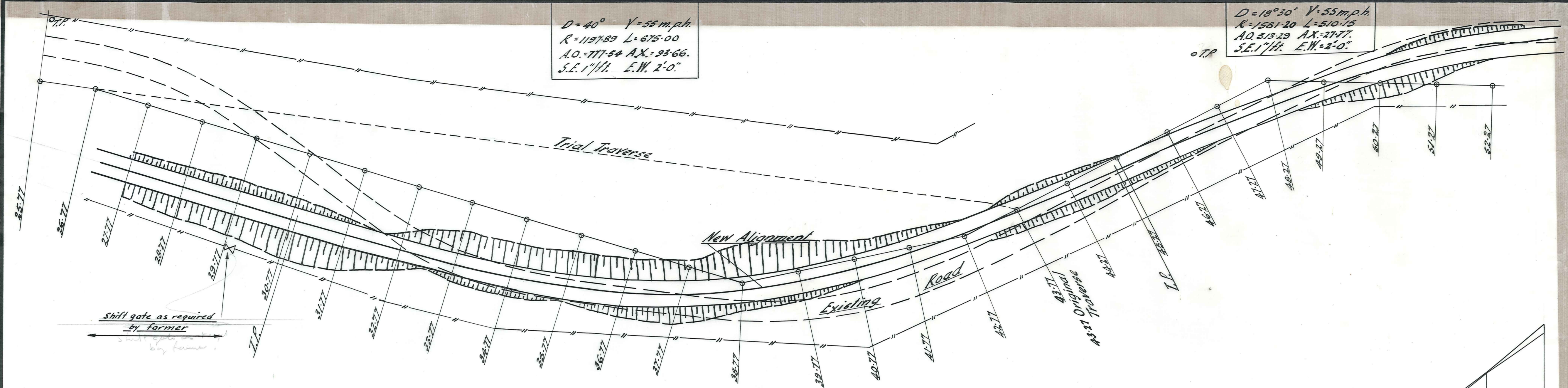

$D = 40^\circ$ $V = 55 \text{ m.p.h.}$
 $R = 1345.91$ $L = 600.00$
 $AO = 792.96$ $AX = 98.19$
 $SE = 1\frac{1}{4}$ $EW = 2'-0"$

$D = 20^\circ$ $V = 55 \text{ m.p.h.}$
 $R = 1521.00$ $L = 530.45$
 $AO = 534.27$ $AX = 31.28$
 $SE = 1\frac{1}{4}$ $EW = 2'-0"$

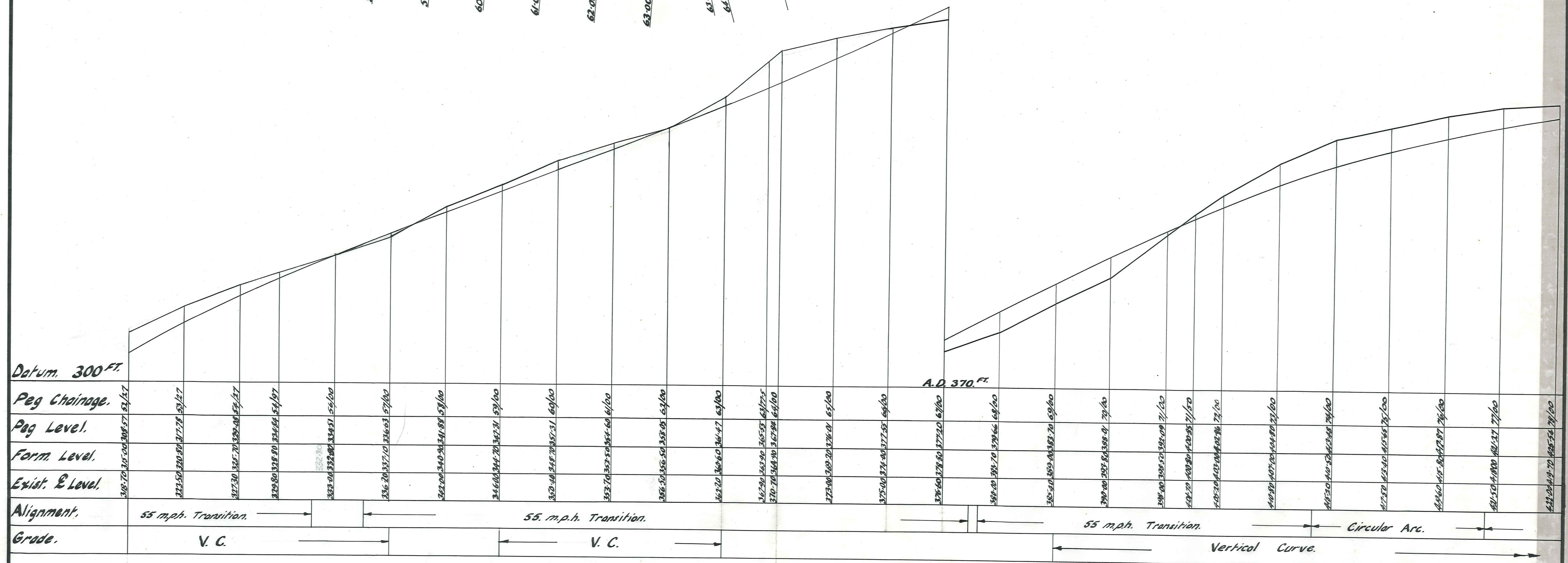
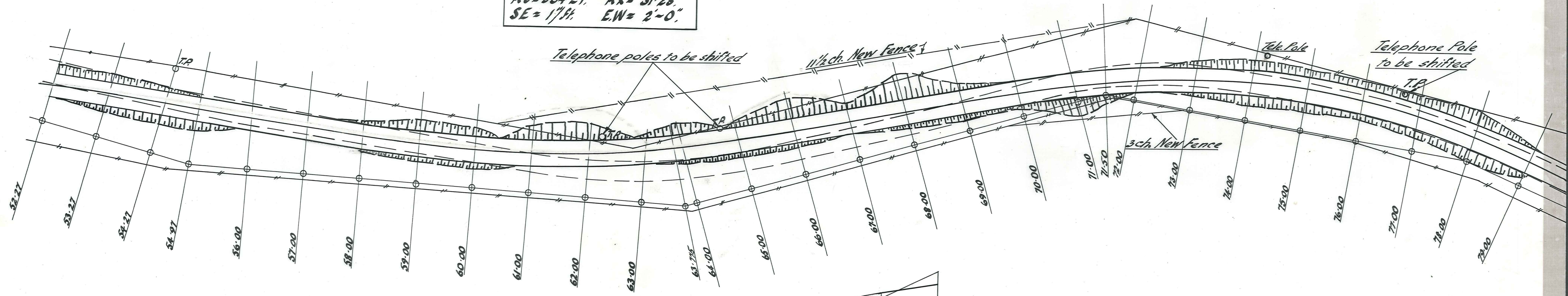

Scales: Horizontal, 1 inch = 1 ch.
 Vertical, 1 inch = 10 ft.

VINCENT COUNTY COUNCIL	BLACKS HILL RD. RECONSTRUCTION 52/27. ~ 78/00.	DUFFILL, WATTS & KING CONSULTING CIVIL & STRUCTURAL ENGINEERS DUNEDIN and INVERCARGILL		SURVEYED BY: G.J. Dixon DRAWN: ... CALCULATIONS: ... CHECKED: ... TRACED: ... APPROVED: ...	NAME: ... DATE: Oct. 64 DATE: Oct. 64 DATE: Nov 64	JOB NO. 4463/3 FILE NO. 64/45
					F.B.K. 136	

V=55 m.p.h. D=52°
 R=1197.89 L=675.00.
 AO=92774 AX=152.43.
 SE.=1"ft. EW.=2'-0"

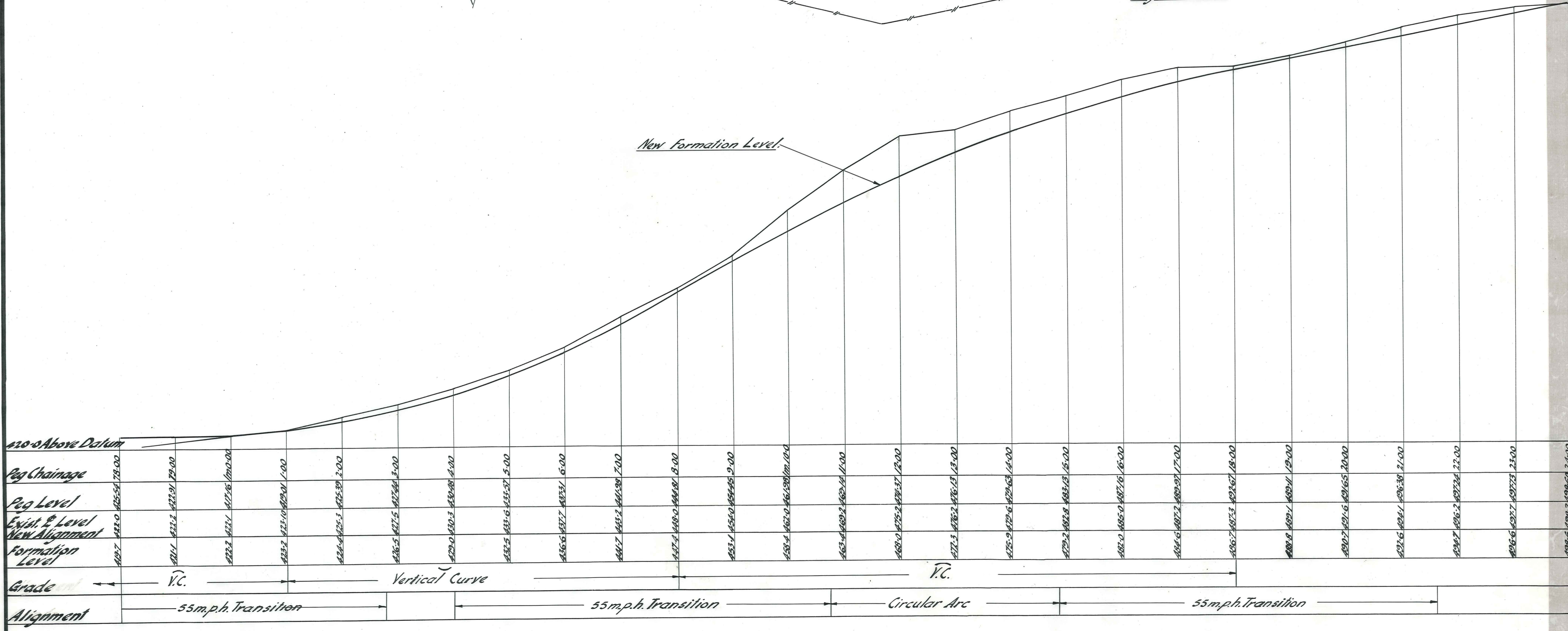
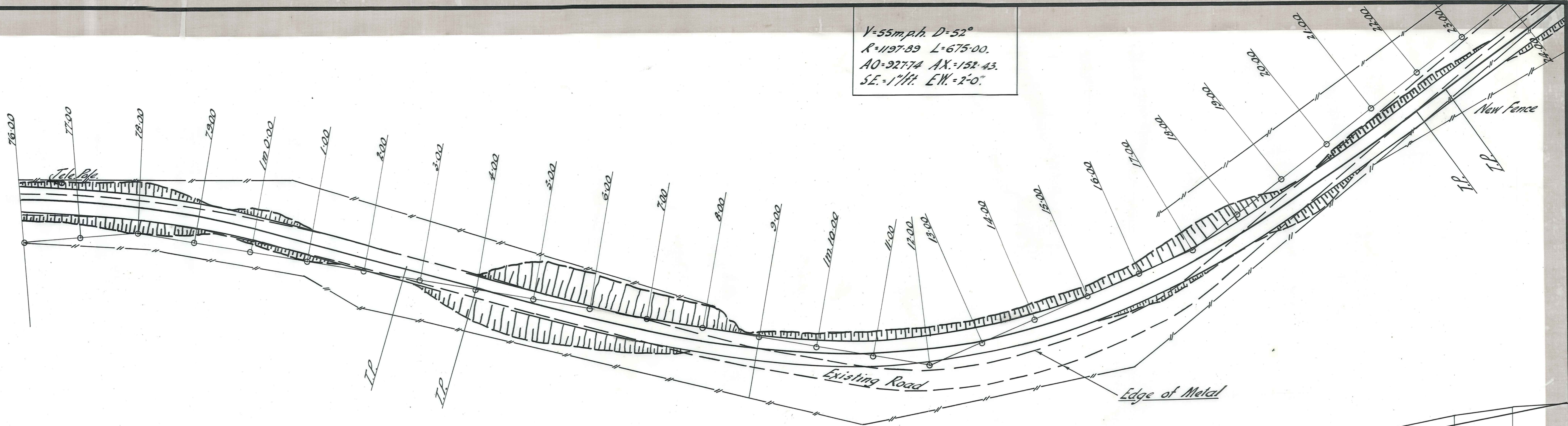

Scales: Horizontal 1 inch = 1 ch.
 Vertical 1 inch = 10 ft.

VINCENT COUNTY COUNCIL	BLACKS HILL RD RECONSTRUCTION 78.00 ~ IM 24.00	DUFFILL, WATTS & KING CONSULTING CIVIL & STRUCTURAL ENGINEERS DUNEDIN and INVERCARGILL	NAME DATE		JOB No. 4463/4
			SURVEYED BY G. Dillon DRAWN CALCULATIONS CHECKED R. D. Warden TRACED APPROVED	Oct. 1964 Nov. 64	

D = 8°30'
 V = 55 m.p.h.
 L = 345.77
 R = 2330.94
 A.O. = 346.19
 A.X. = 8.57
 S.E. = 0.7"/ft.
 E.W. = 2'-0"

D = 18°
 V = 65 m.p.h.
 R = 2244.0
 L = 704.49
 A.O. = 708.58
 A.X. = 37.28
 S.E. = 1"/ft. E.W. = 2'-0"

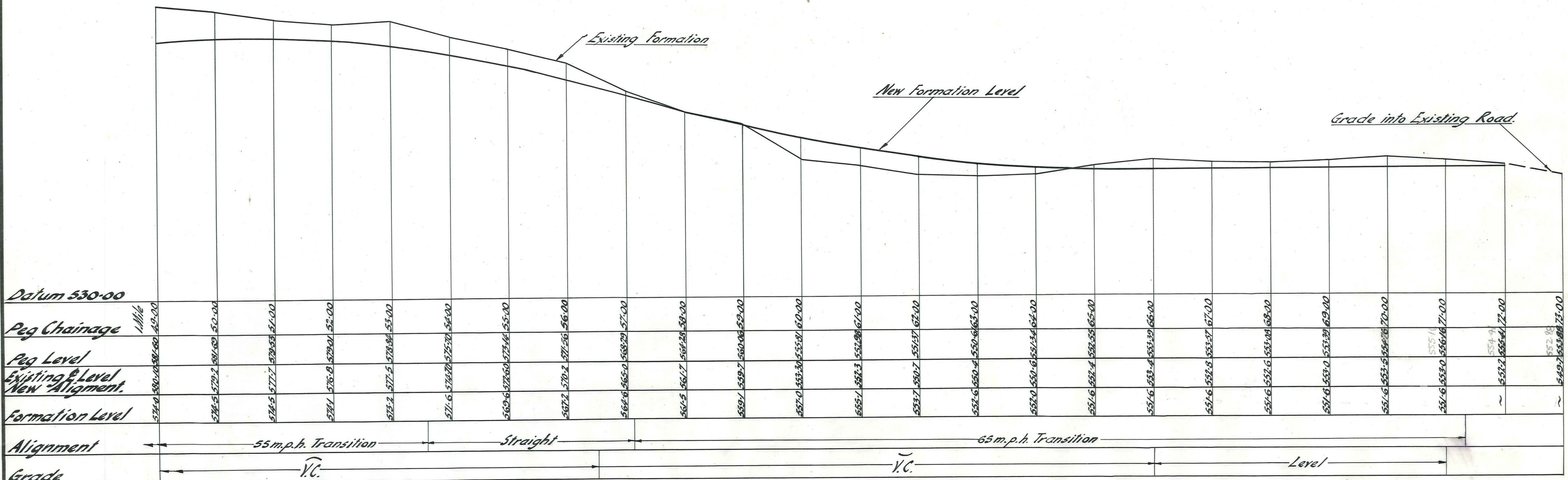
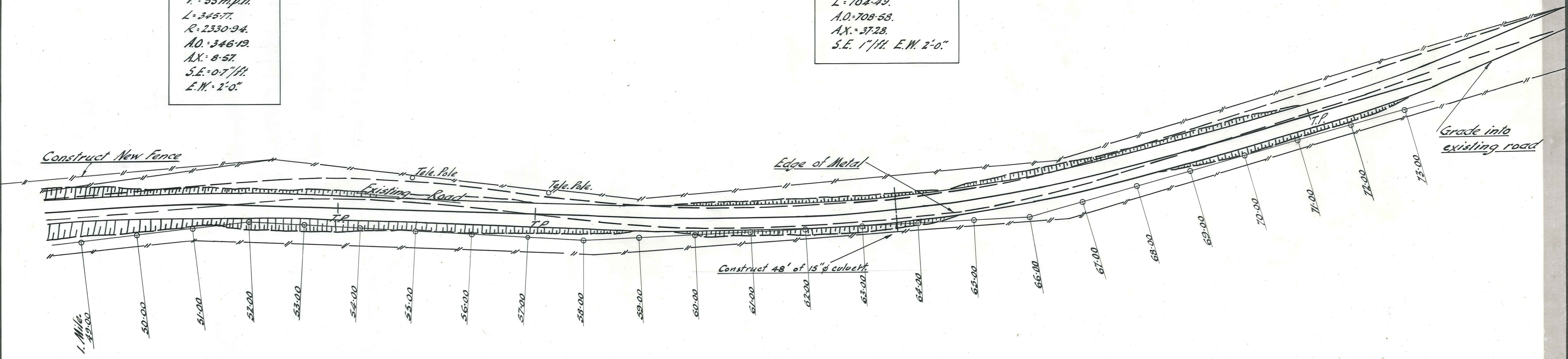

Scales: Horizontal, 1 inch = 1 ch.
 Vertical, 10 ft. = 1 inch.

VINCENT COUNTY COUNCIL

BLACKS HILL ROAD RECONSTRUCTION
 1 MILE 49.00 ~ 1 MILE 73.00

DUFFILL, WATTS & KING
 CONSULTING CIVIL & STRUCTURAL ENGINEERS
 DUNEDIN and INVERCARGILL

SURVEYED BY	C. Dillon	DATE	Aug. 1964
DRAWN			
CALCULATIONS			
CHECKED	R. Dymond	DATE	Oct. 1964
TRACED			
APPROVED			

JOB NO. 4463/6
 FEB 1965 FILE NO. 4/4

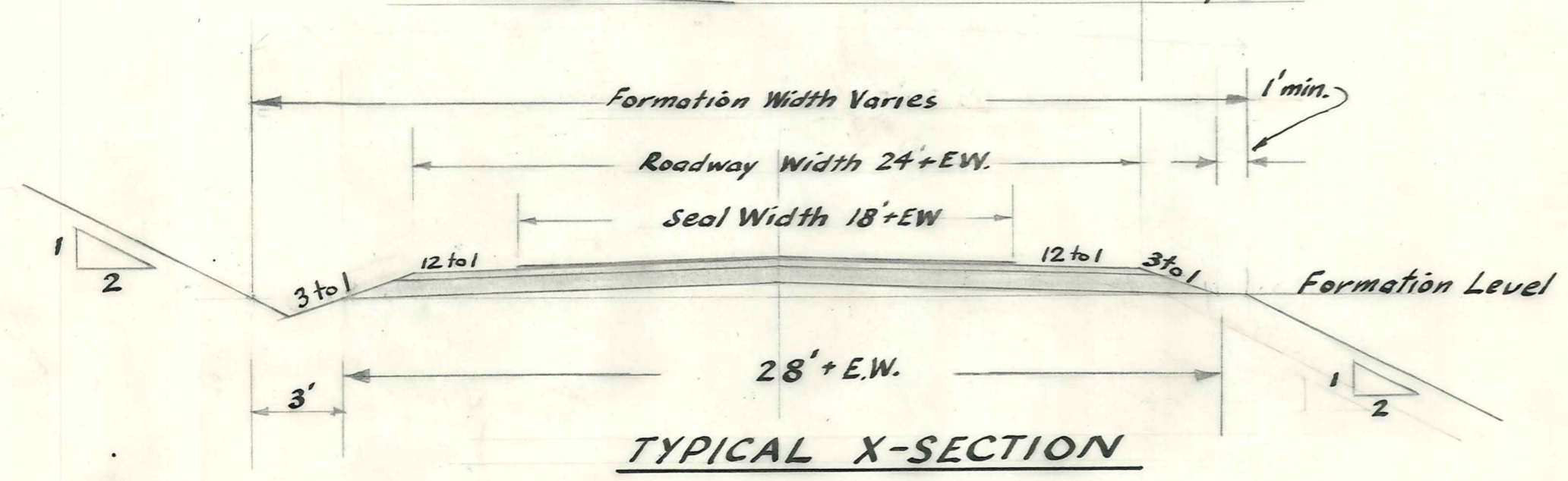
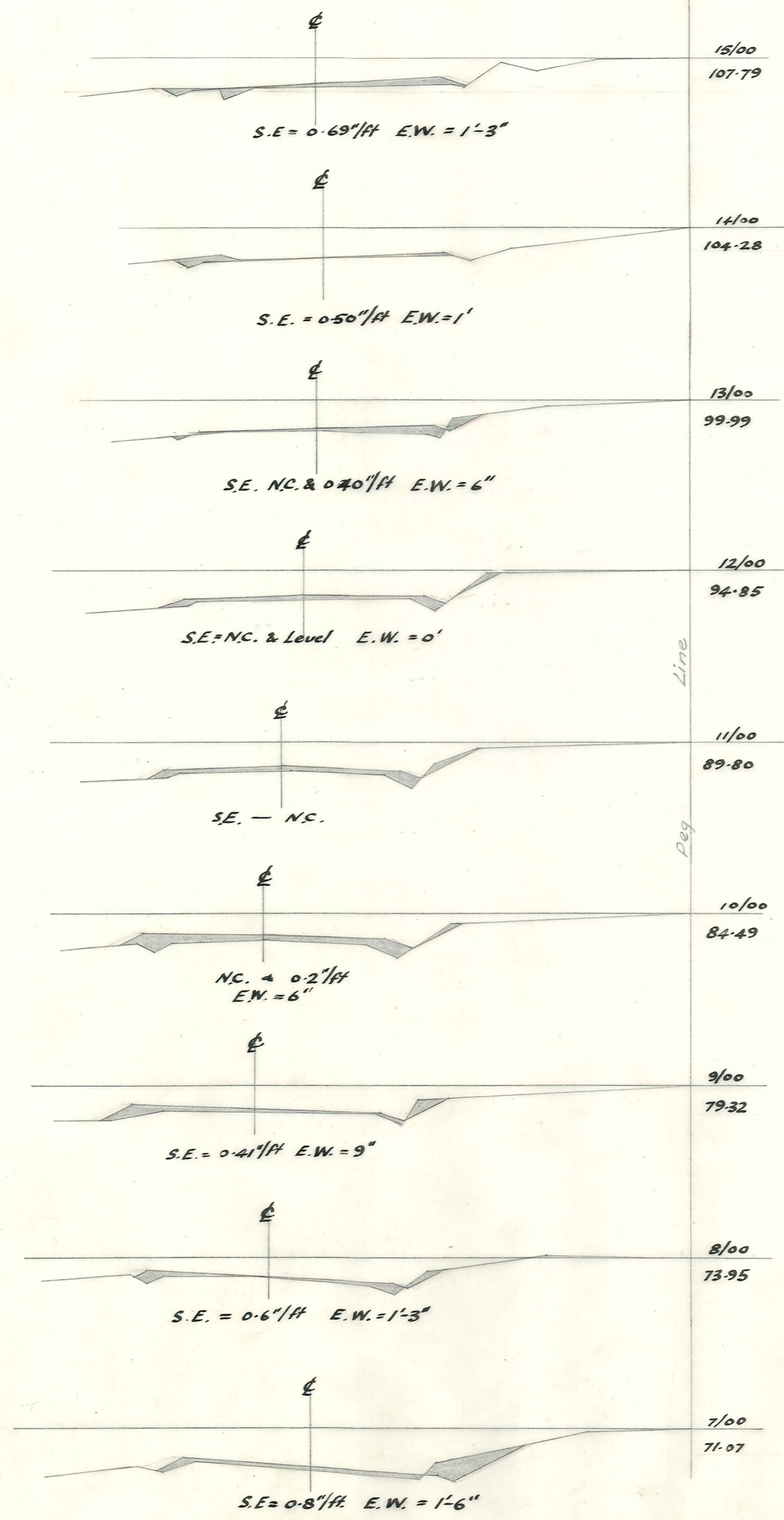
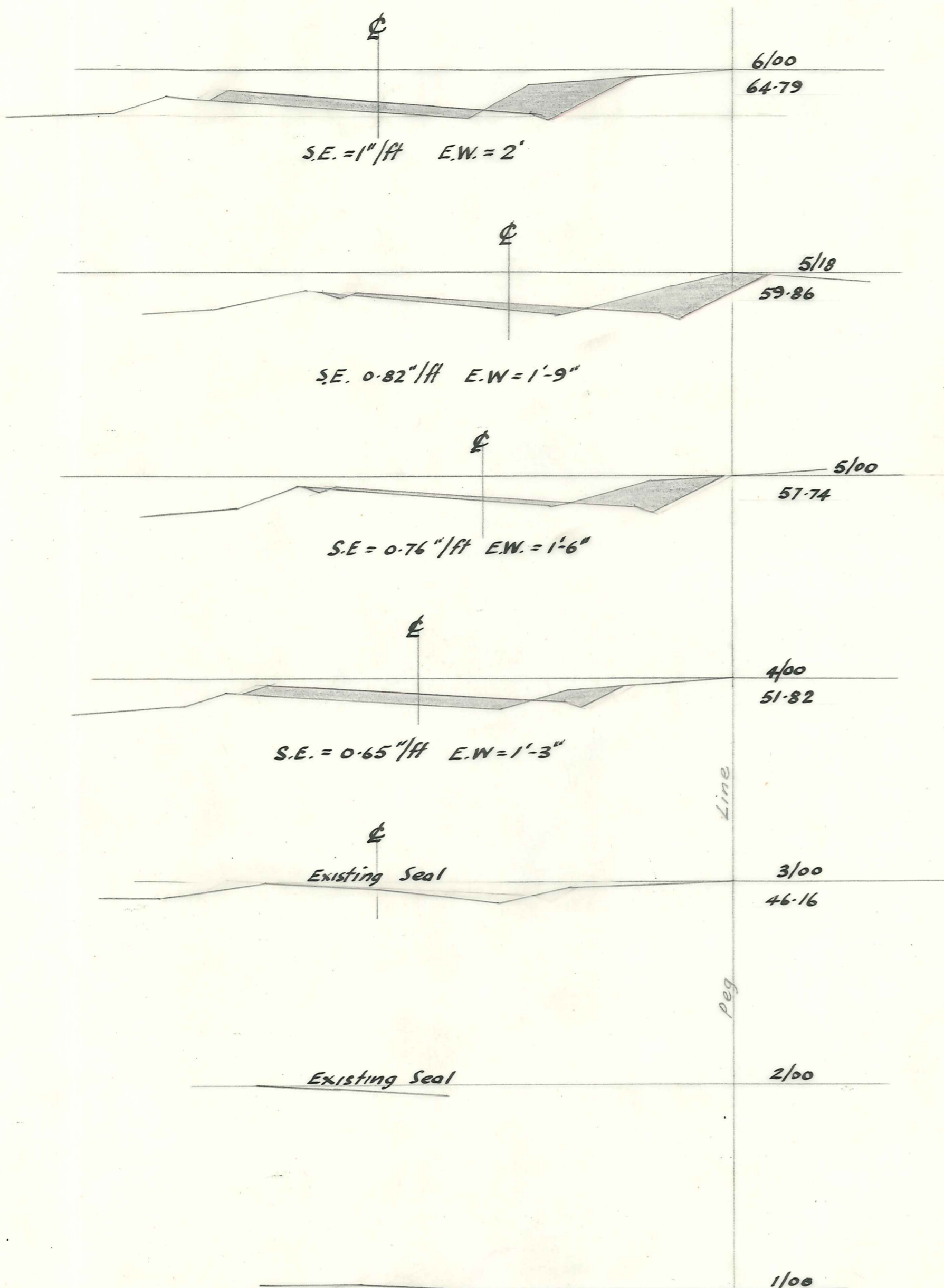

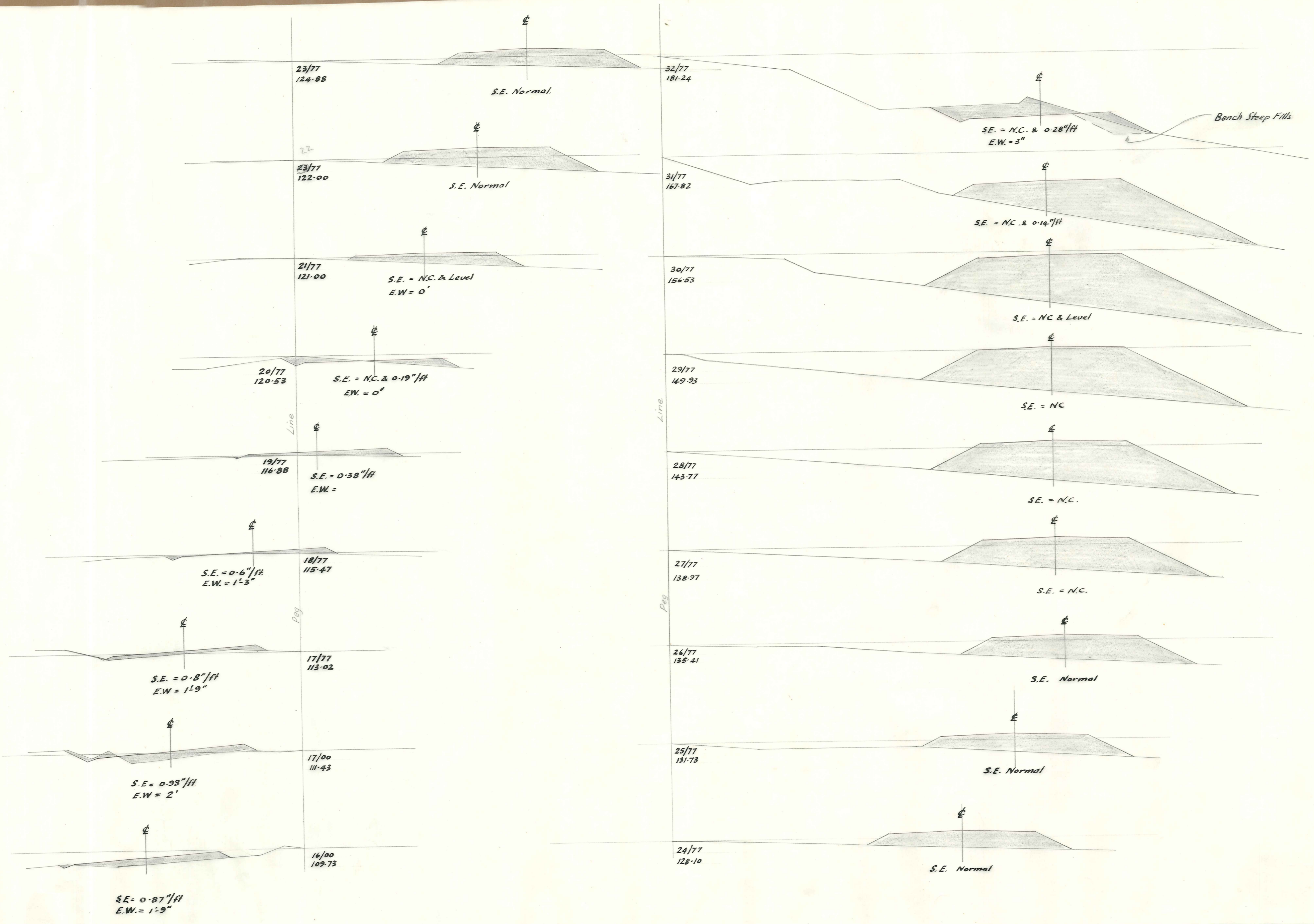

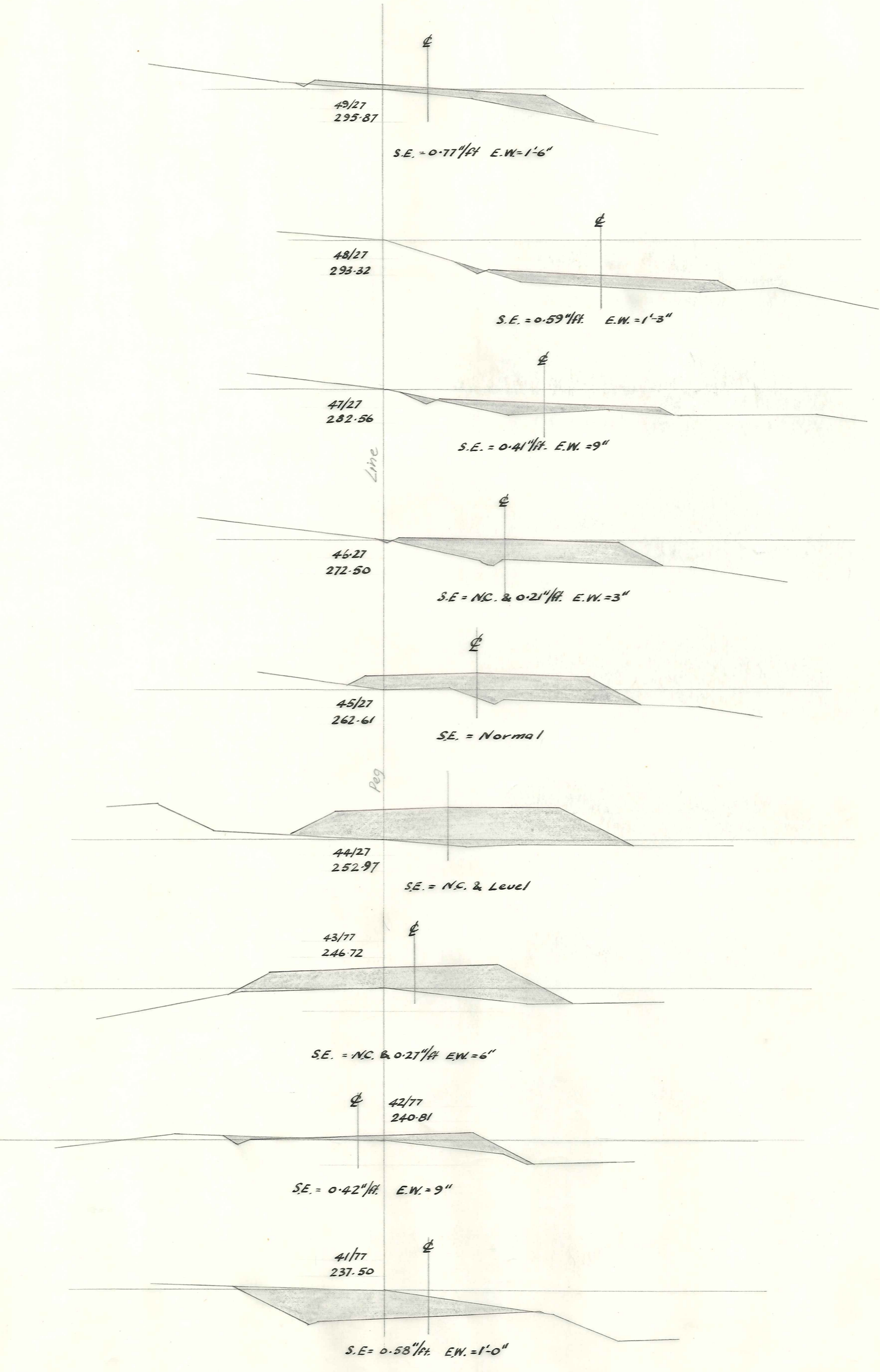
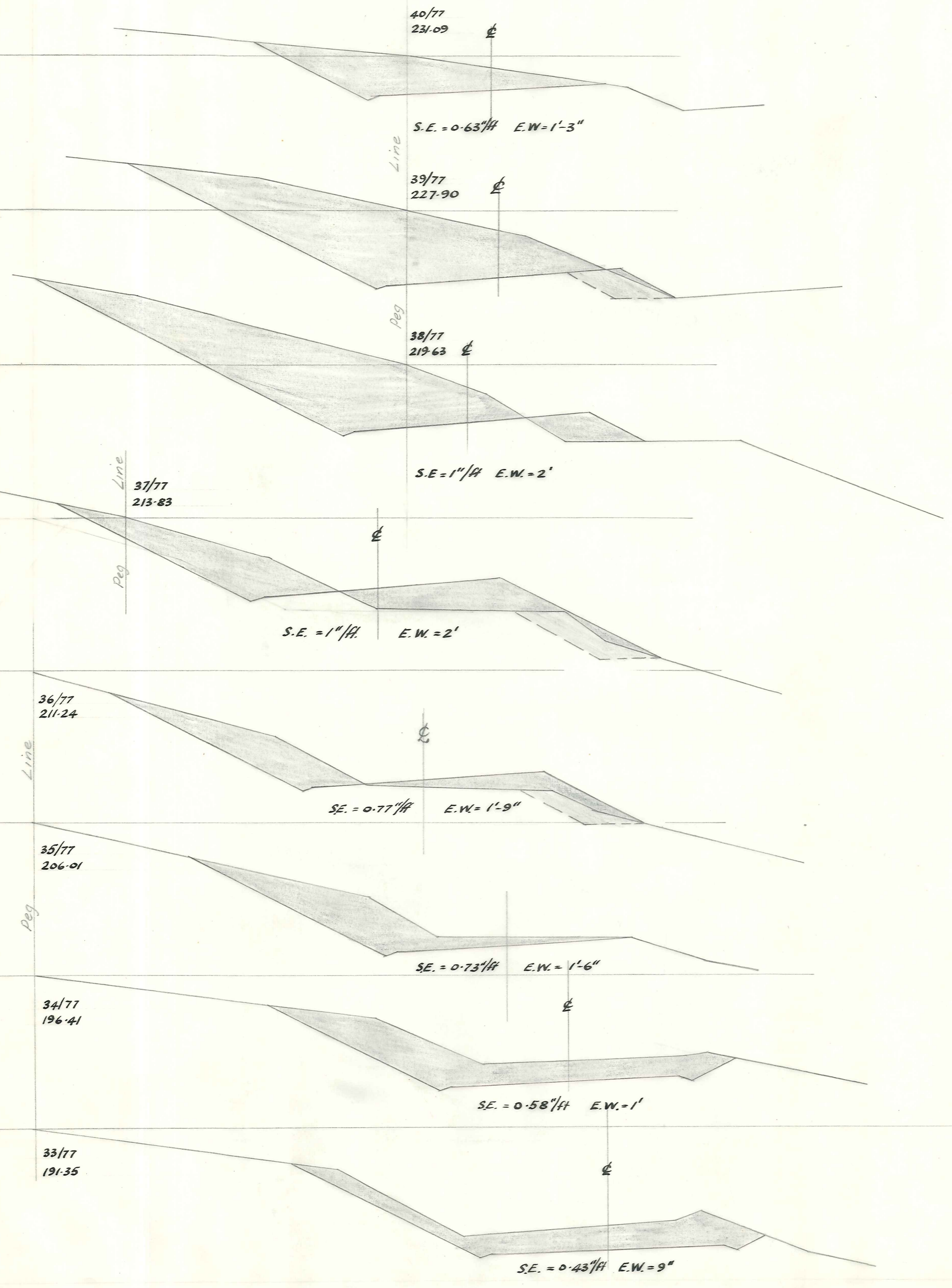

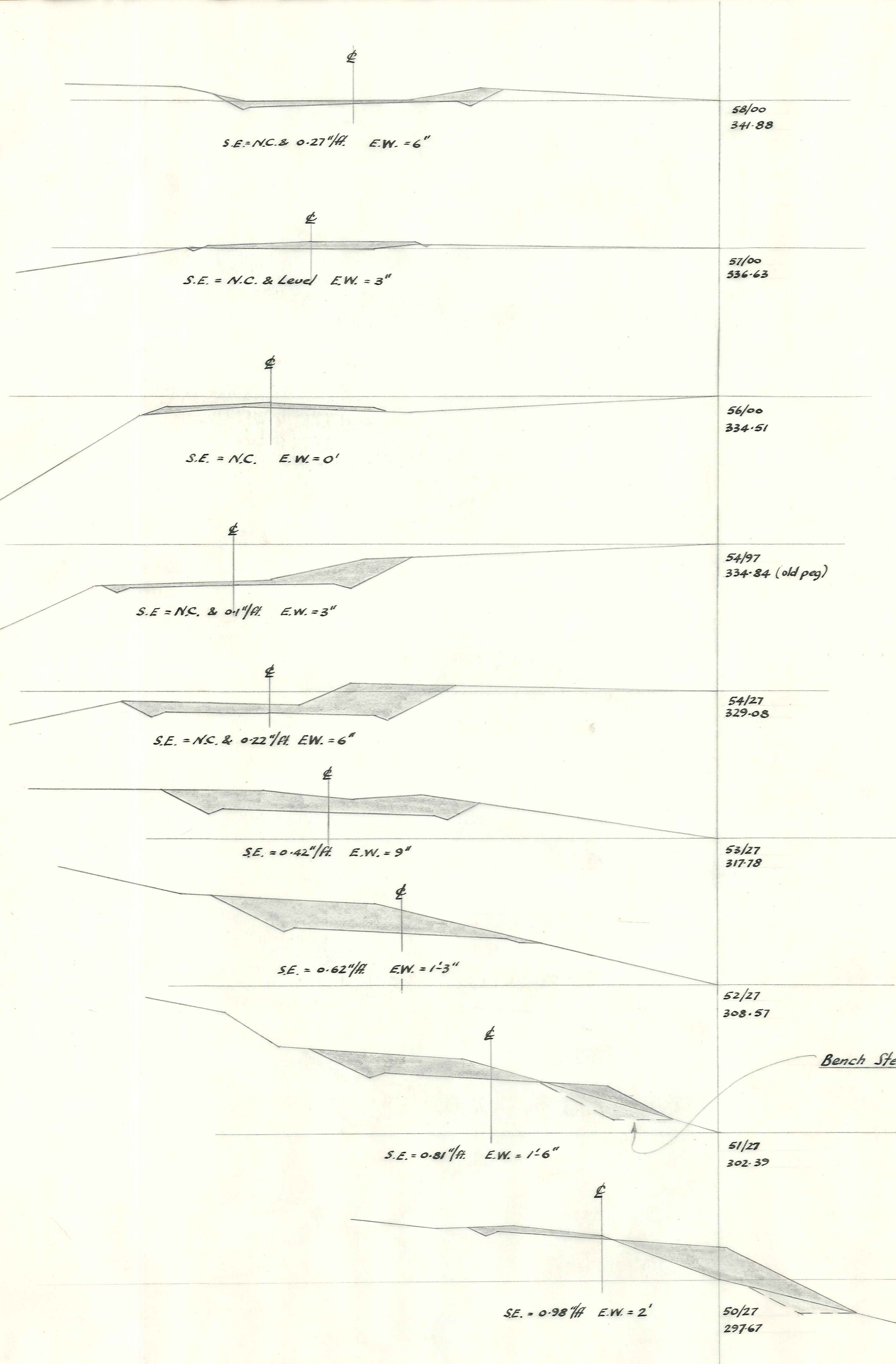

Bench Steep or High Fills

