

VINCENT COUNTY COUNCIL

CROMWELL LOWBURN BYPASS RECONSTRUCTION

AMENDMENTS					NAME	DATE
No.	By	Date	Description	Apprd.	G. J. Dillon	APRIL 66
					"	"
					"	"
					J. Paton	MAY 66

DUFFILL, WATTS & KING
CONSULTING CIVIL & STRUCTURAL ENGINEERS
DUNEDIN & INVERCARGILL N.Z.

File 4/46
L.B.K. 215
F.B.K.
JOB No. 4639
Sheet 1 of 5 Sheets

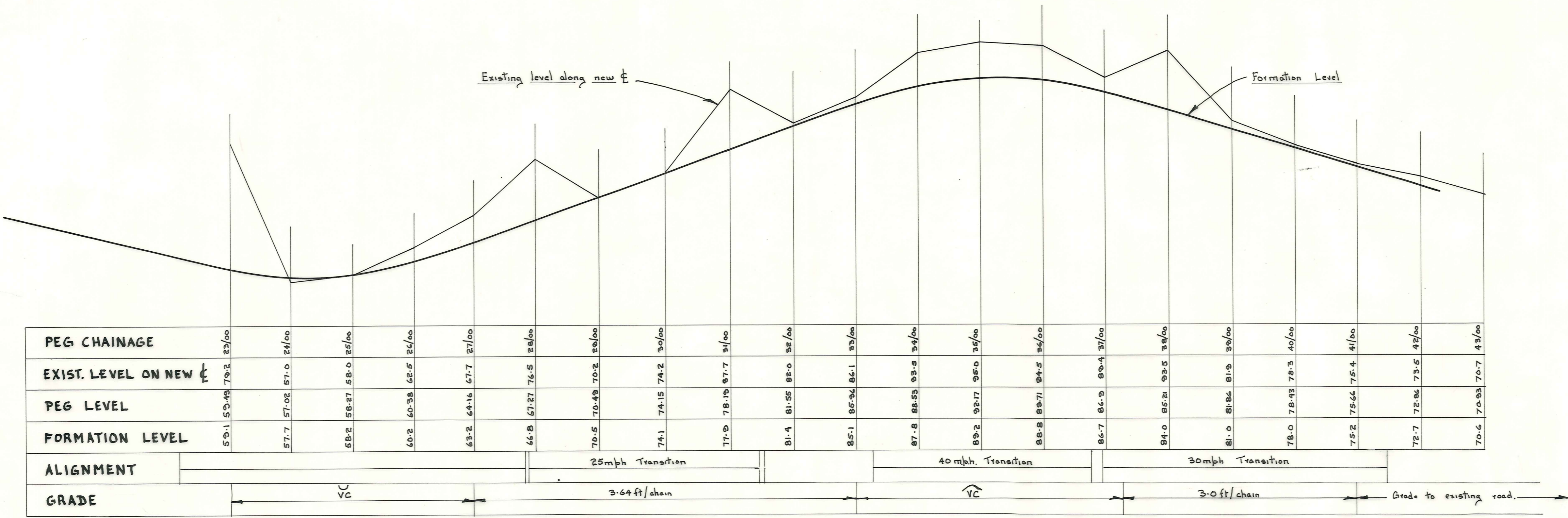
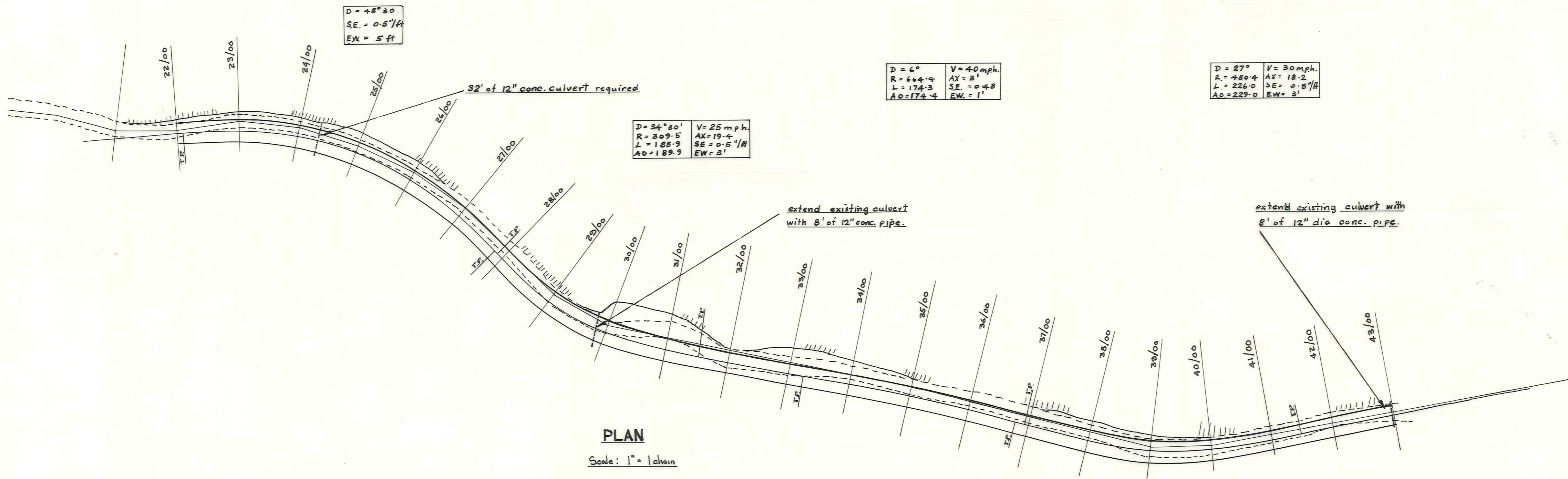

VINCENT
COUNTY COUNCIL

CROMWELL LOWBURN BYPASS
RECONSTRUCTION

AMENDMENTS					NAME	DATE
No.	By	Date	Description	Apprd.		
					G. J. Dillon	April 66
					"	"
					J. Paton	"

DUFFILL, WATTS & KING
CONSULTING CIVIL & STRUCTURAL ENGINEERS
DUNEDIN & INVERCARGILL N.Z.

File
4/66
L. Bk.
215
F. Bk.

JOB No.
4639

Sheet 2 of 5 Sheets

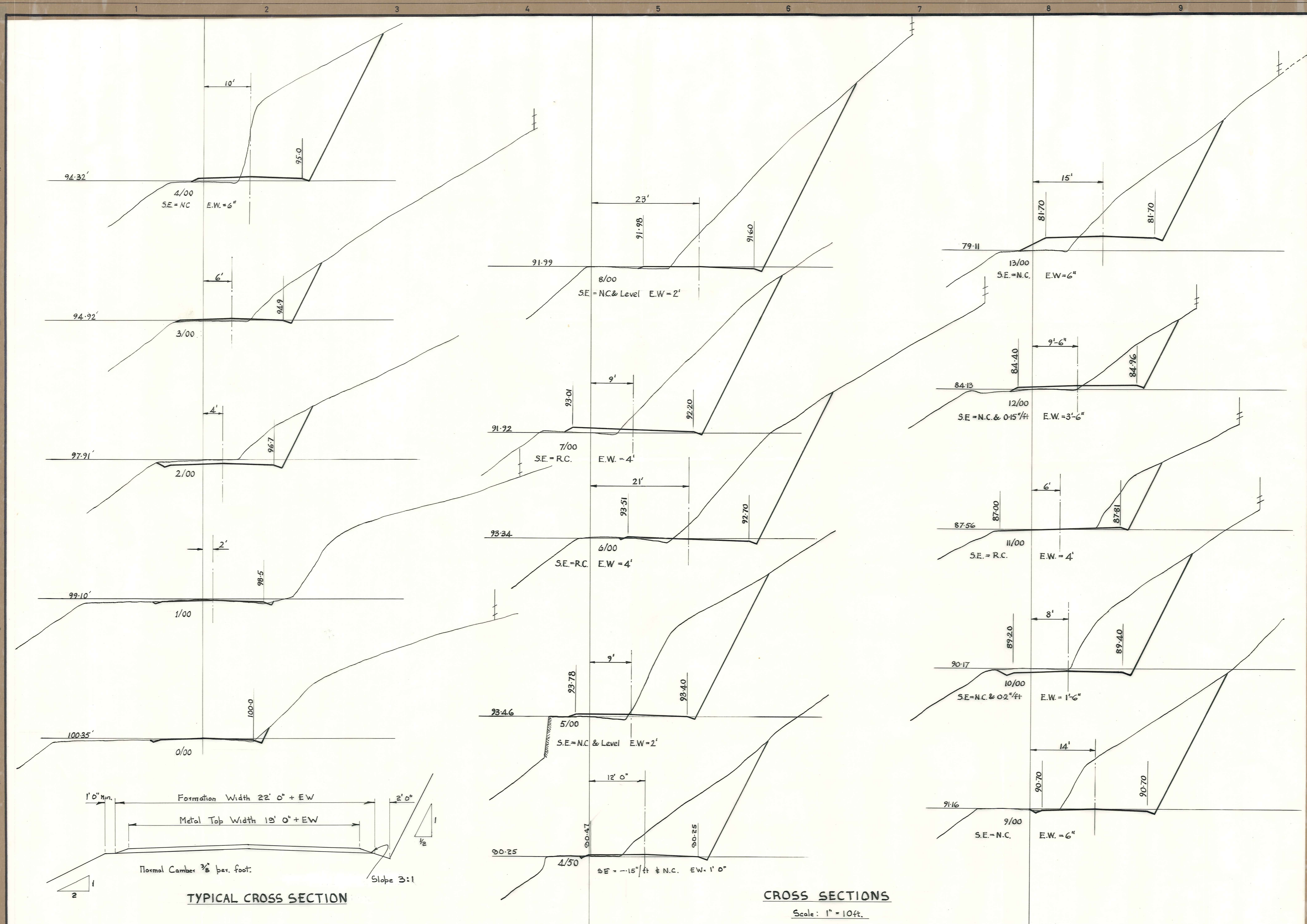

VINCENT
COUNTY COUNCIL

CROMWELL LOWBURN BYPASS
RECONSTRUCTION

AMENDMENTS					NAME	DATE
No.	By	Date	Description	Apprd.	Surveyed	Apr 1 66
					Drawn	"
					Calculations	"
					Traced	H.A.W. Barr
					Checked	"
					Approved	"

DUFFILL, WATTS & KING
CONSULTING CIVIL & STRUCTURAL ENGINEERS
DUNEDIN & INVERCARGILL N.Z.

File
4/66
L.Bk.
215
F.Bk.
JOB No.
4639
Sheet 3 of 5 Sheets

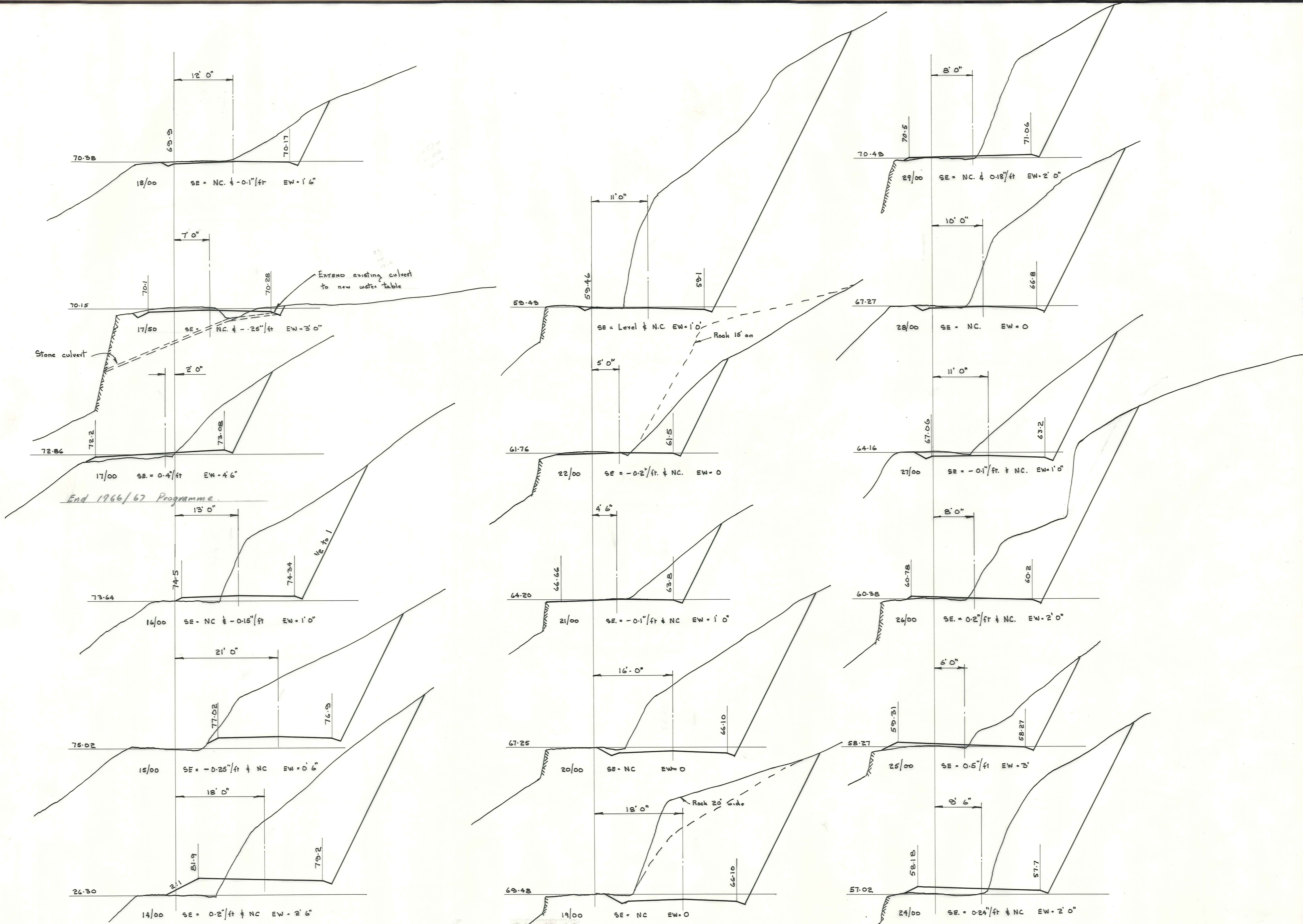

CROSS SECTIONS

Scale: 1" = 10ft.

VINCENT
COUNTY COUNCIL

CROMWELL LOWBURN BYPASS
RECONSTRUCTION

AMENDMENTS						NAME	DATE
No.	By	Date	Description	Apprd.	Surveyed	G. J. Dillon	May 66
					Drawn		
					Calculations		
					Traced	J. Peten	
					Checked		
					Approved		

DUFFILL, WATTS & KING
CONSULTING CIVIL & STRUCTURAL ENGINEERS
DUNEDIN & INVERCARGILL N.Z.

File
4/46
L. Bk.
215
F. Bk.

JOB No.
4639

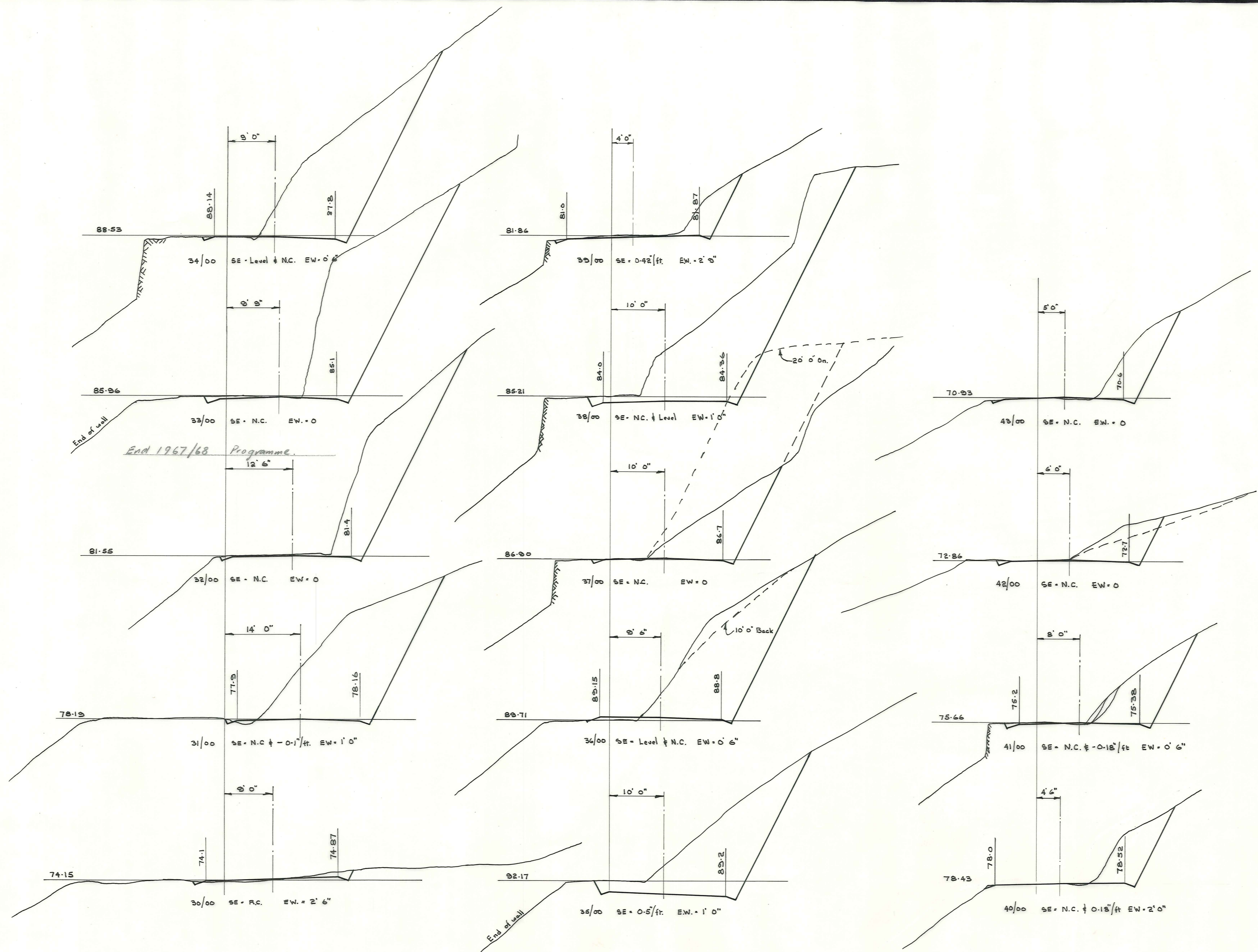

CROSS SECTIONS

Scale: 1" = 10ft.

VINCENT
COUNTY COUNCIL

CROMWELL LOWBURN BYPASS
RECONSTRUCTION

AMENDMENTS					NAME	DATE
No.	By	Date	Description	Apprd.	G. J. Dillan	April 66
					J. Paton	

DUFFILL, WATTS & KING
CONSULTING CIVIL & STRUCTURAL ENGINEERS
DUNEDIN & INVERCARGILL N.Z.

File
4/46
L. Bk.
215
F. Bk.

JOB No.
4639