

Crown Land (2-1-30-1 & 0-1-20) Set Apart for Road Gaz 1965 p490

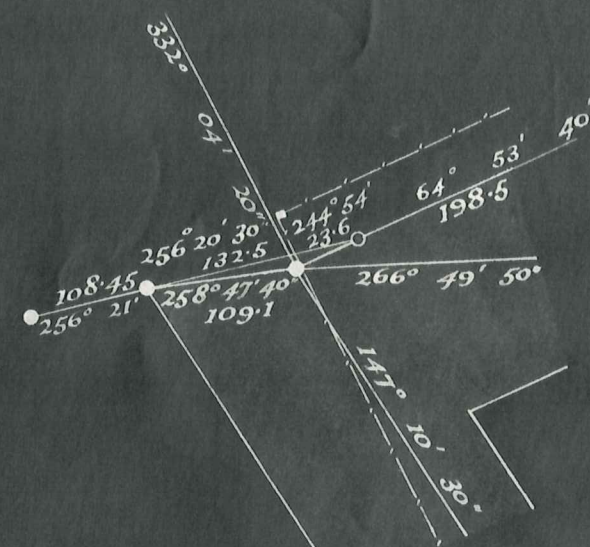

Diagram of Origin

PUBLIC WORKS OFFICE
DUNEDIN
APPROVED
J. C. [Signature]
DISTRICT ENGINEER

FILE: IX/208
AUTHORITY:
PARENT PLAN: 80841 and 860
REF. PLANS: S.O. 873, 5017, 5030, 5036, 5293
Received: 7.4.42 No. 9316
Fieldbook: 1352 Page: 9-15
Traverse-book: 52 folio: 13+14
Examined: Shortall 5/8/42
Recorded: B.J. Smith 31/3/44
Plan in order and ready for approval:

Plan of Road Deviation through Secs. 79, 123, and Crown Land, Block I, Leaning Rock S.D. Otago Land District, Vincent County.

Surveyed by A.J. Houlston Registered Surveyor. Date: October 1940

SCALE: 3 CHAINS TO AN INCH.

I, Adam John Houlston of Dunedin Registered Surveyor, hereby certify that this plan has been made from surveys executed by me; that both plan and survey are correct, and have been made in accordance with the rules of the Survey Board.
Dated at Dunedin this 31st day of July 1942
A.J. Houlston Registered Surveyor.

Approved as from
Survey agrees with Court order.
H. Adams Chief Surveyor 719142
Plan No. 15500 Nof (1)

9316