

NOTE: LIP OF CHANNEL 0.255 ABOVE FORMATION LEV.  
KERB & CHANNEL AND FOOTPATH EXTEND FROM OPPOSITE MARK 44.5 TO OPPOSITE MARK 500  
MUDSUMPS IN CHANNEL AT DISTANCES 150, 300, & 400.

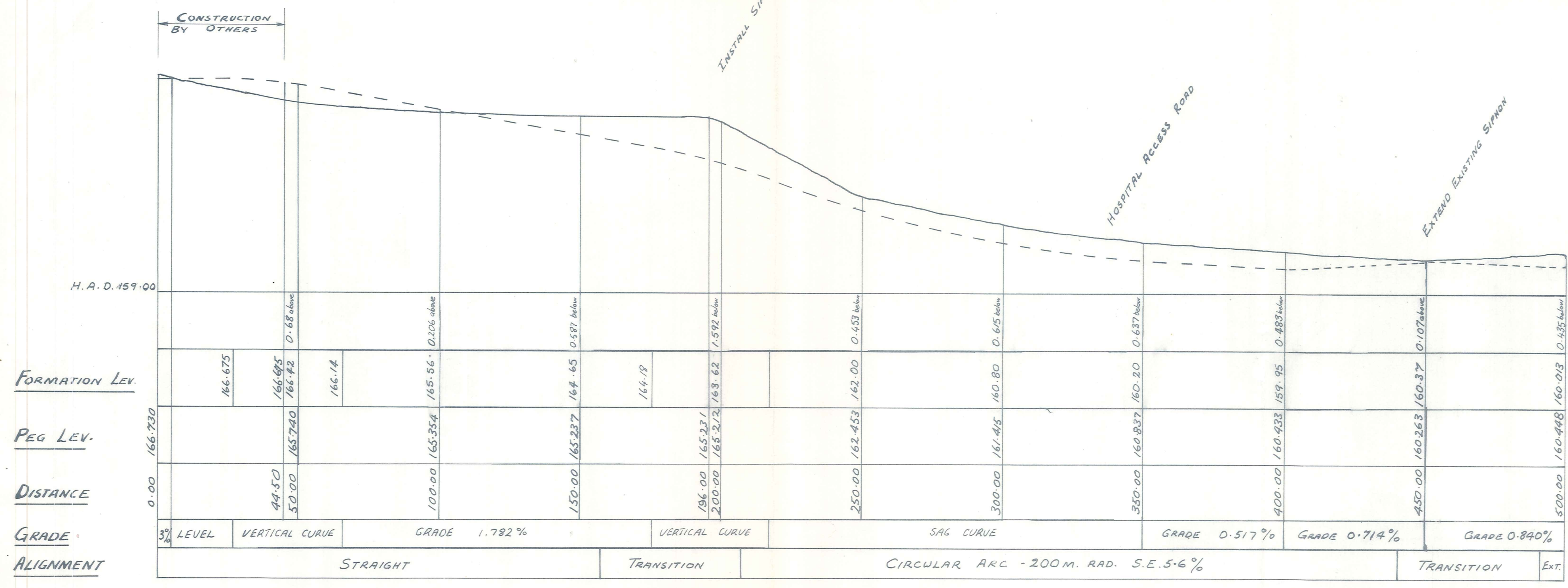

LONGITUDINAL SECTION  
HORIZ. SCALE 1:1000 VERT. SCALE 1:100

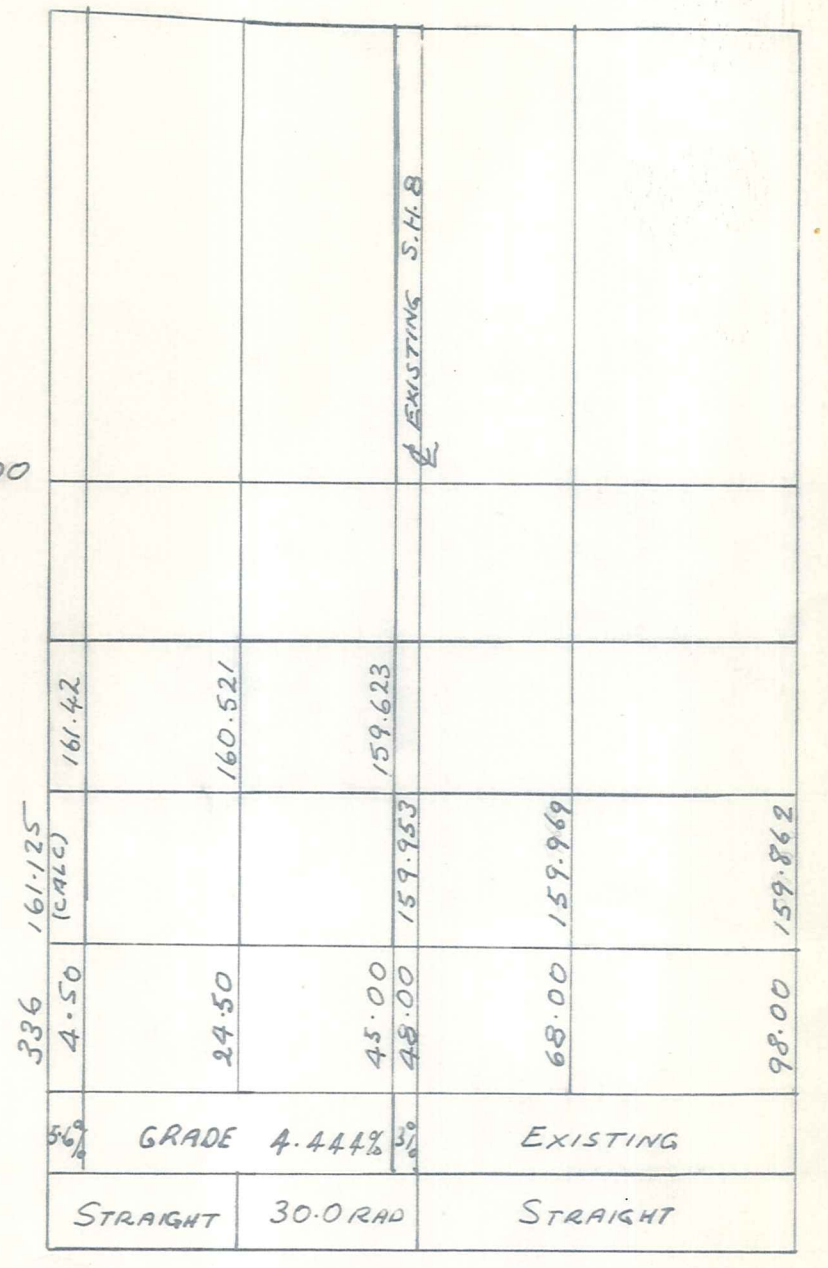

HOSPITAL ENTRANCE  
LONGITUDINAL SECTION  
SCALES HORIZ 1:1000 VERT 1:500

DUFFILL WATTS & KING LTD  
CONSULTING CIVIL & STRUCTURAL ENGINEERS  
Dunedin PO Box 5269 Ph 777-133 Invercargill PO Box 576 Ph 83-049  
Balclutha PO Box 220 Ph 81-664 Cromwell PO Box 82 Ph 50-391

MINISTRY  
OF  
WORKS & DEVELOPMENT

VINCENT COUNTY COUNCIL  
CLYDE ROADING  
SOUTHERN ACCESS ~ LINE A.

DATUM  
M.W.D.B.M.  
D125  
ORIGIN  
M.S.L.

NO.	BY	DATE	AMENDMENTS	Appvd.	NAME	DATE
1	GY	3/80	Re-grade		P. COLDICOTT	MAR. 80
					G. YATES	" "
					" "	" "
					" "	" "
					" "	" "
					" "	" "

JOB NO.	Sheet No
7761	1A
File 131	L.B.365
F.B.	



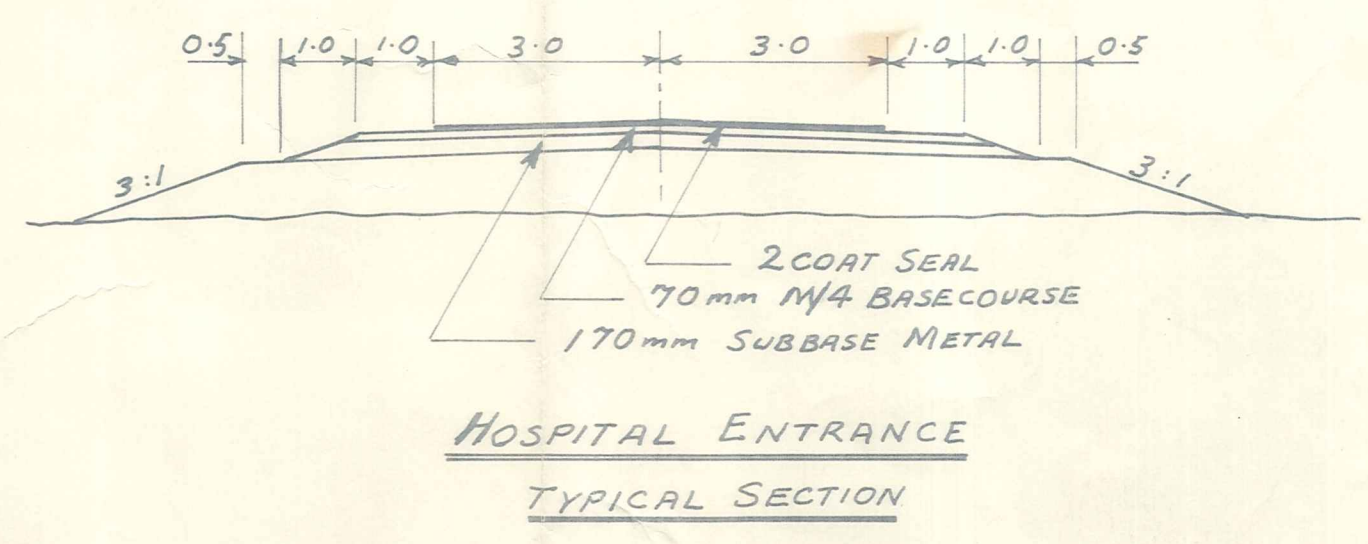
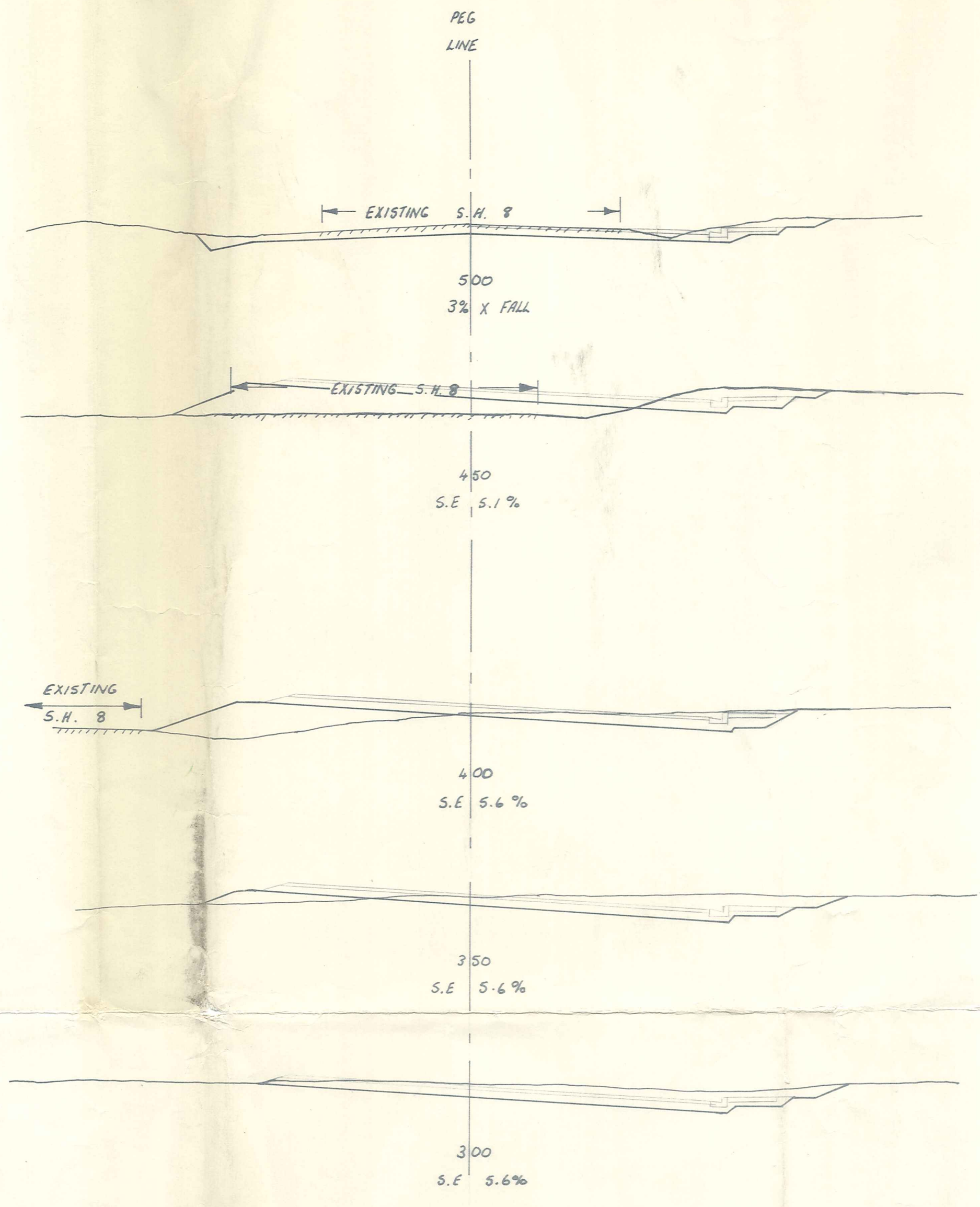
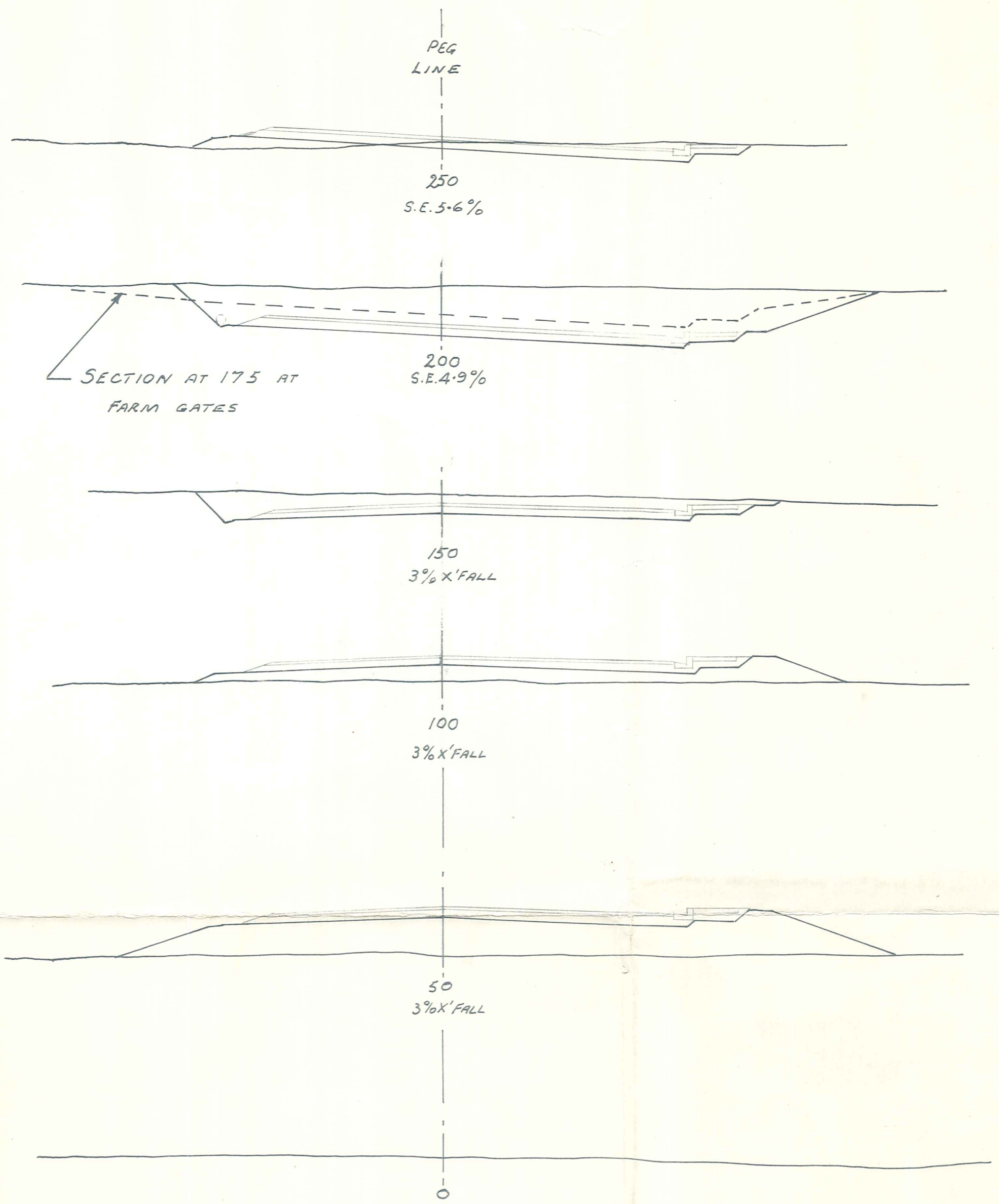

CROSS SECTIONS  
SCALE 1:100

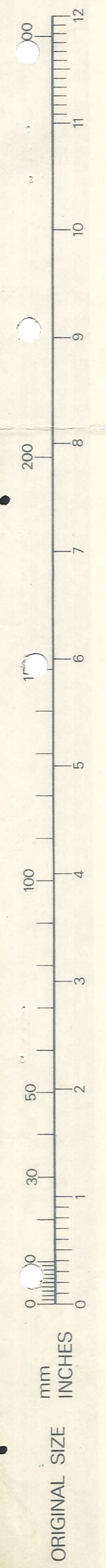

DUFFILL WATTS & KING LTD  
CONSULTING CIVIL & STRUCTURAL ENGINEERS  
Dunedin P.O.Box 5299 Ph 777-133 Invercargill P.O.Box 576 Ph 83-049  
Balclutha P.O.Box 220 Ph 81-664 Cromwell P.O.Box 82 Ph 50-391

MINISTRY  
OF  
WORKS & DEVELOPMENT

VINCENT COUNTY COUNCIL  
CLYDE ROADING  
SOUTHERN ACCESS ~ LINE A.

DATUM  
M.W.D.B.M.  
D125  
ORIGIN  
M.S.L.

AMENDMENTS			Appvd	NAME	DATE
NO.	BY	DATE			
A	G.Y.	20-3-80		P. COLDIKOTT	MAR-80
		REGRADE		P.C. & G.Y.	" "
				G. YATES	" "
				"	" "
				"	" "
				"	" "
				"	" "
				"	" "
				"	" "

Surveyed  
Drawn  
Calculations  
Traced  
Checked  
Approved

JOB NO.  
7761  
File 131 L.B. 365

Sheet No.  
2A  
of 2 sheets  
F.B.