

AVAILABLE FROM ALL LEADING OFFICE EQUIPMENT DEALERS

As Built
 Gilling Place
 Antimony Cres
 Goldfields Primary School, Kindergarten, Cobb Court,

15/4/20/5/2
 NUMBER 0510
 SIZE A1

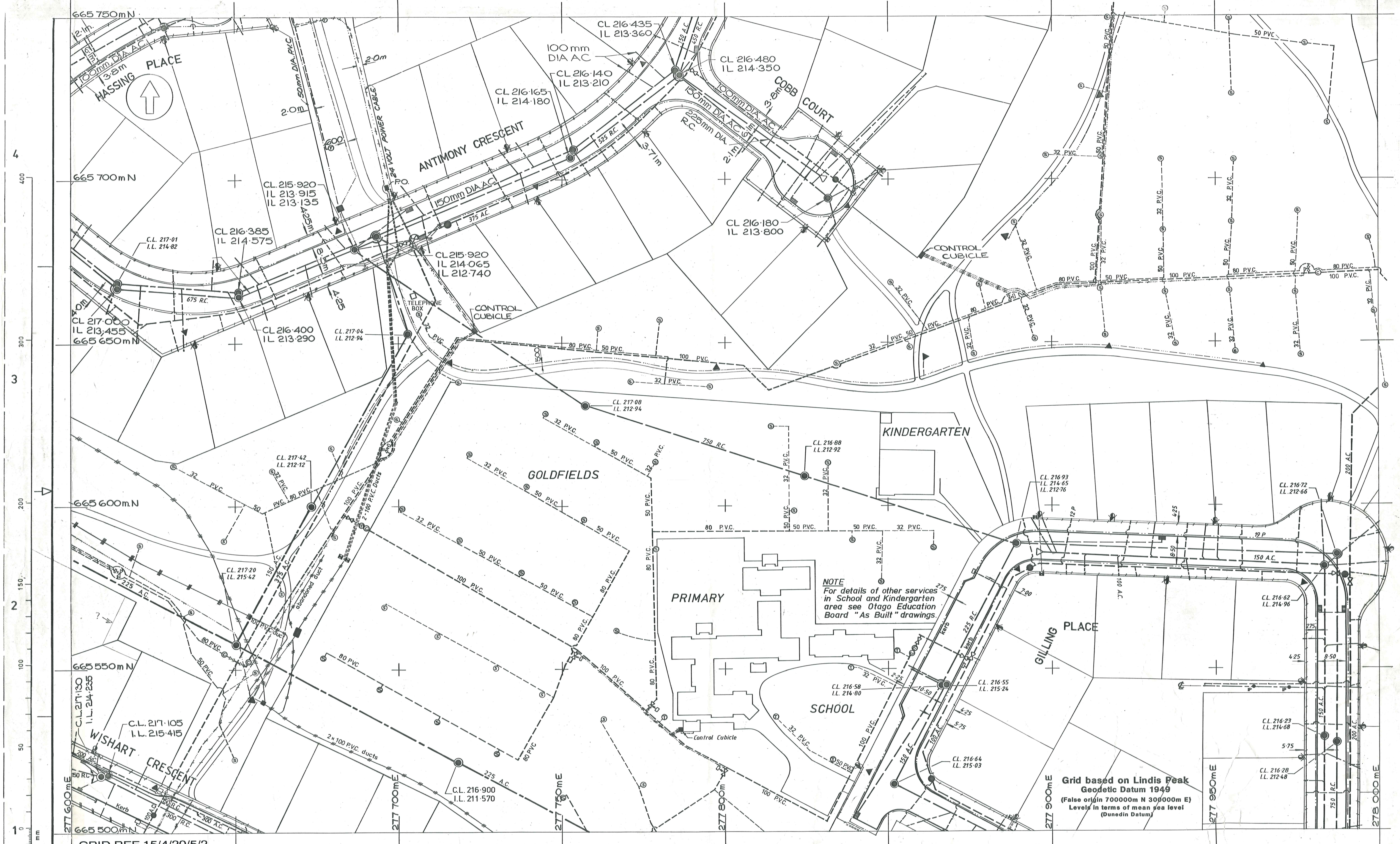

NOTE
 For details of other services
 in School and Kindergarten
 area see Otago Education
 Board "As Built" drawings.

Grid based on Lindis Peak
 Geodetic Datum 1949
 (False origin 700000m N 300000m E)
 Levels in terms of mean sea level
 (Dunedin Datum)

GRID REF 15/4/20/5/2

ORIGINAL SIZE
 A1

AMENDMENTS				BY	APPD.	DATE	FOR T STORY PROJECT ENGINEER	<p>Ministry of Works and Development</p> <p>POWER</p> <p>H. W. ROBERTSON CHIEF POWER ENGINEER</p> <p>N.C. McLEOD Commissioner</p>	<p>CLUTHA VALLEY DEVELOPMENT</p> <p>CROMWELL EXPANSION</p> <p>AREA 20-5 : "AS BUILT" SERVICES</p>				ORIGINAL SCALES	1:500	FILE	
DRAWN <i>[Signature]</i> 25/8/78 COMPILED <i>[Signature]</i> 6-7-79 SUPERVISED <i>[Signature]</i> 25-9-78							APPROVED						JOB	CODE	SHEET	REVISION
BY <i>[Signature]</i> 20/9/83							RECOMMENDED									

Whole numbers = mm
 Decimalised expressions = m