

Curve data
 SV = 50 km/h
 SE = 5.20 %
 TT = 89.28m
 I = 46°
 R = 143.24m
 E = 13.37
 SL = 56.25 m
 L = 58.75 m

PLAN Scale 1:500

- Notes:
1. Culvert pipes to be existing relocated to new position and 1200mm dia ex Neville lane works
 2. Proposed culvert to be laid on invert of new stream bed
 R.L invert = 91.30m
 R.L outlet = 90.80m

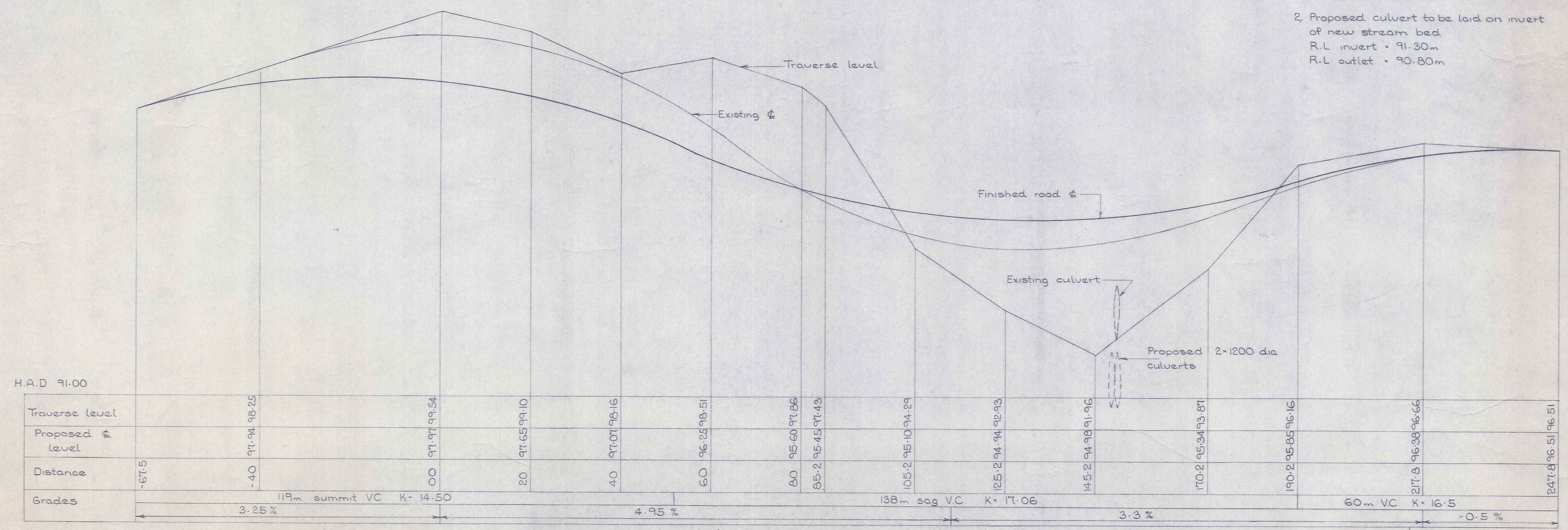

LONGITUDINAL SECTION Scale Horiz 1:500 Vert 1:50

DUFFILL WATTS & KING LTD
 CONSULTING CIVIL & STRUCTURAL ENGINEERS
 Dunedin P.O. Box 5269 Ph. 777-133 Invercargill P.O. Box 576 Ph. 83-049
 Alexandra P.O. Box 313 Ph. 6819

VINCENT COUNTY COUNCIL

FELTON ROAD
 CULVERT REPLACEMENT

AMENDMENTS				NAME		DATE	JOB NO.	Sheet No
NO.	BY	DATE	Appvd.	Surveyed	B.H	8-84	13051	1
				Drawn	S.K			
				Calculations	M.B			of 2 shts
				Traced	S.K	8-84		
				Checked	M. Watts	9-84		
				Approved	D. Watts			

File 4043/25 Misc L.B. 428 F.B.

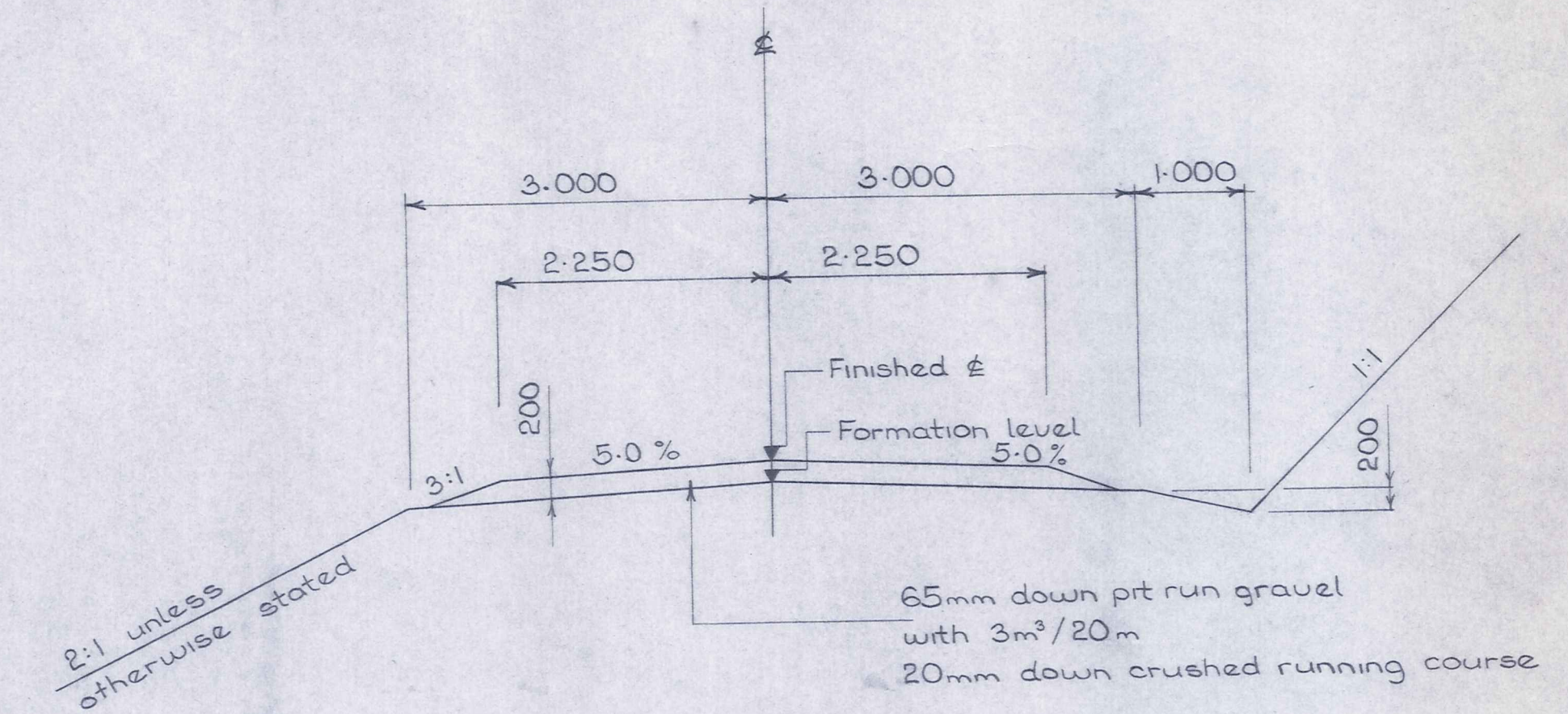
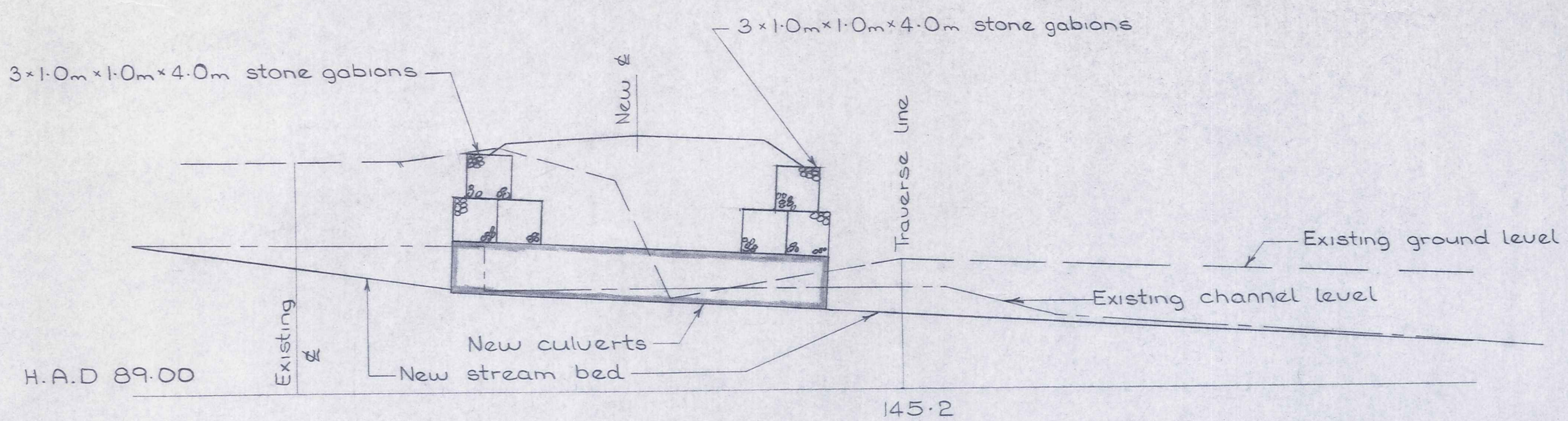

TYPICAL CROSS SECTION
Scale 1:50

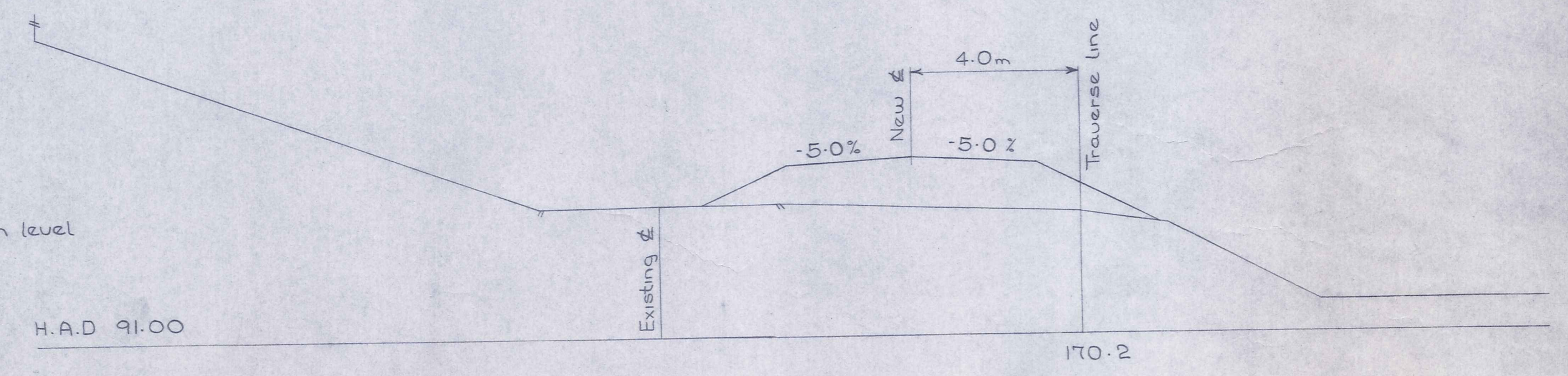
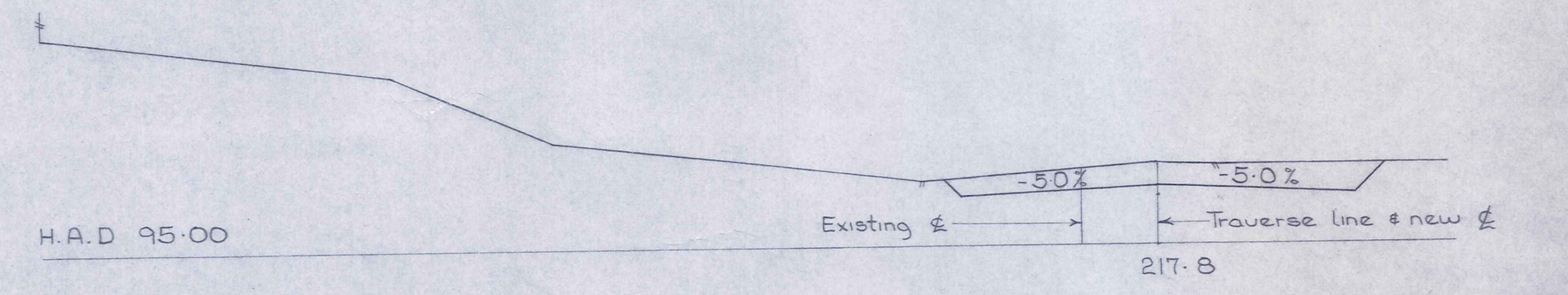
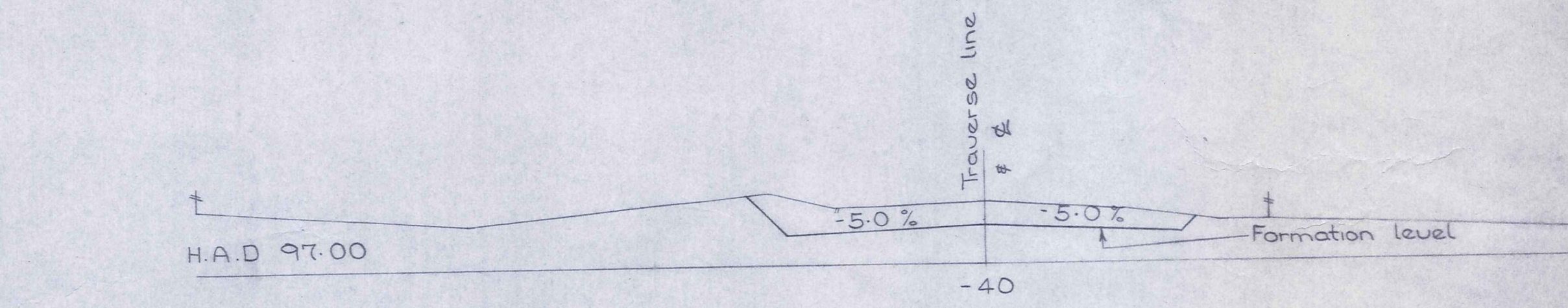
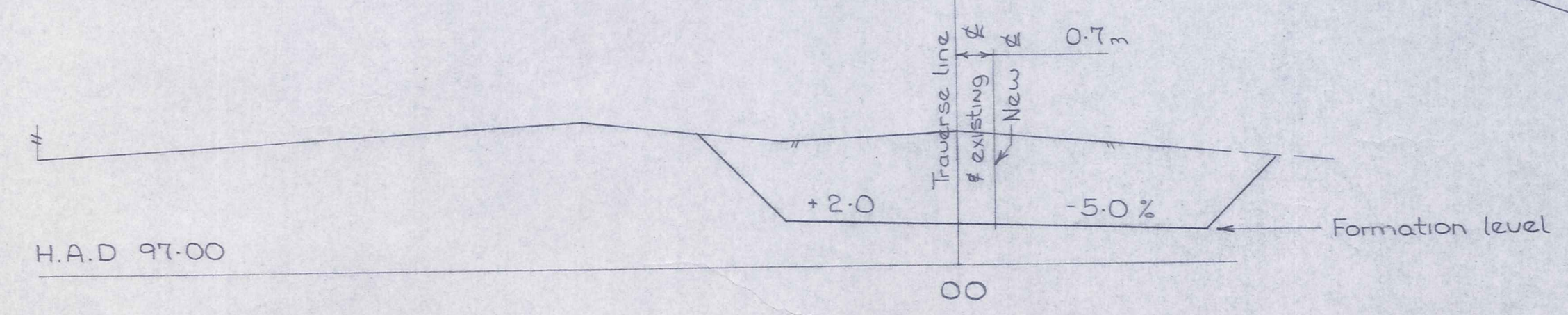
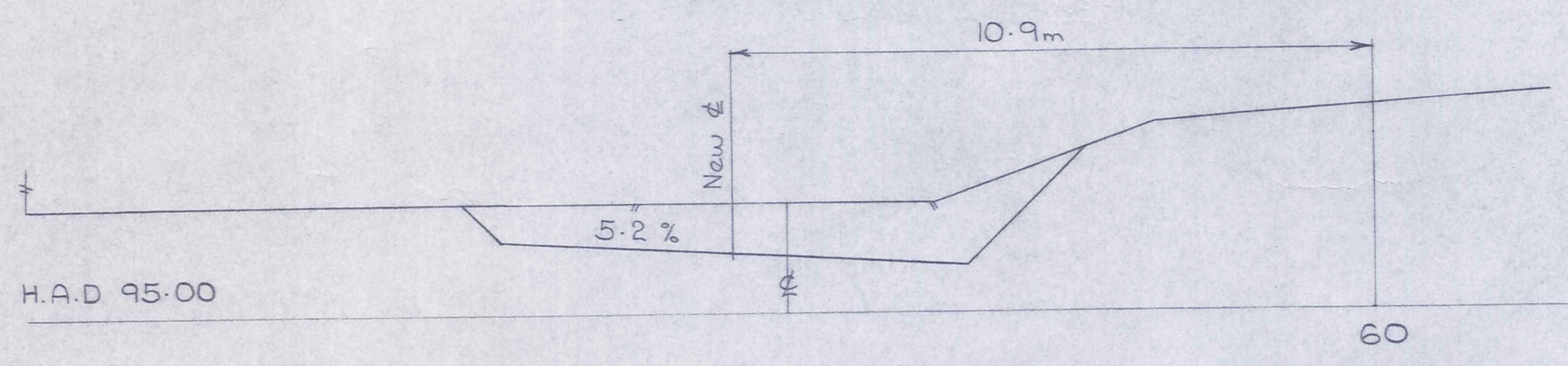
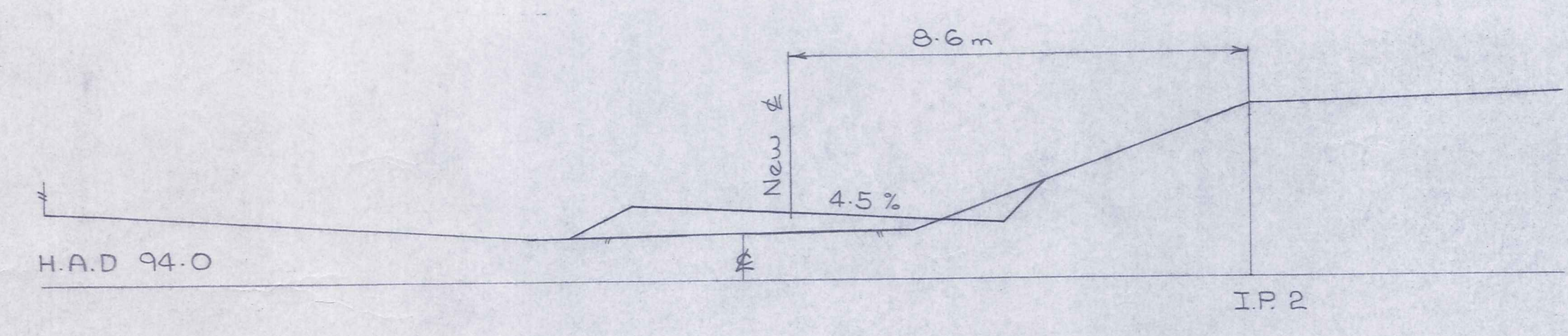
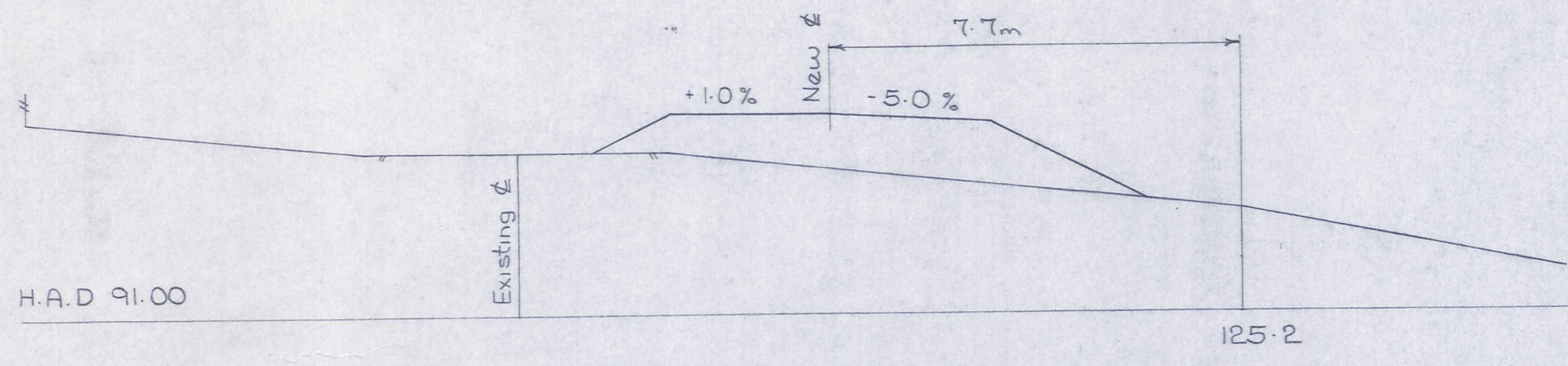

Scale 1:100

ORIGINAL SIZE
mm INCHES

DUFFILL WATTS & KING LTD
CONSULTING CIVIL & STRUCTURAL ENGINEERS
Dunedin P.O. Box 5269 Ph. 777-133 Invercargill P.O. Box 576 Ph. 83-049
Alexandra P.O. Box 313 Ph. 6819

VINCENT
COUNTY COUNCIL

FELTON ROAD
CULVERT REPLACEMENT

AMENDMENTS			NAME	DATE	JOB NO.	Sheet No
NO.	BY	DATE	Appvd.	Surveyed	B.H	8-84
				Drawn	S.K	
				Calculations	M.B	
				Traced	S.K	8-84
				Checked	M. Baker	9-84
				Approved	D. Watts	

File 4043/25 M16C LB. 428 F.B.

13051

2
of 2 shts