

THOMAS STREET

NORTHLAND STREET

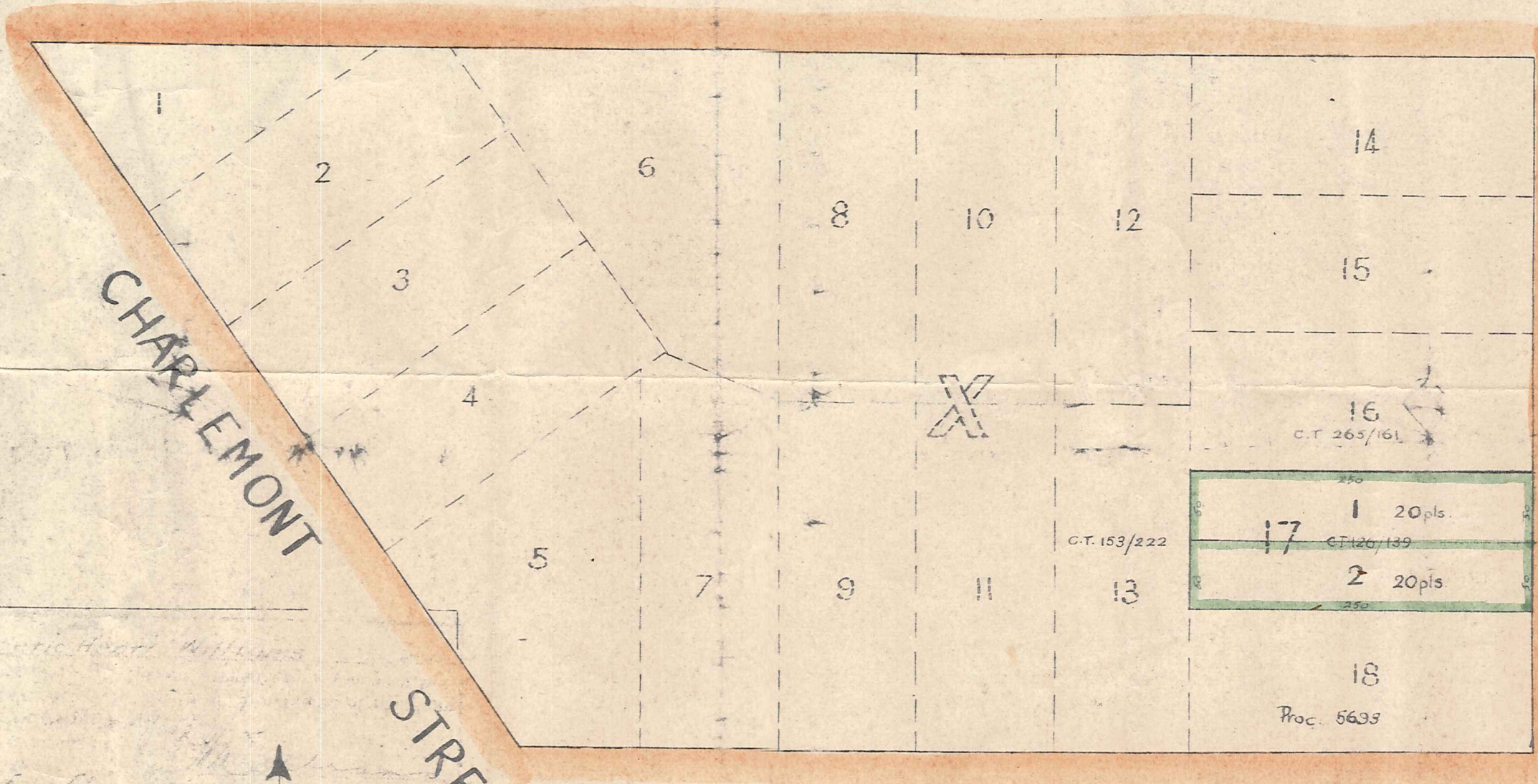

CHARLEMONT STREET

NORTHLAND STREET

Registered Owner

J. Anderson

JOHN STREET

Town of Ranfurly Extension N^o 14

Plan of

Proposed Subdivision of Pt Sec 17

Block X TOWN OF RANFURLY
MANIOTOTO COUNTY OTAGO LAND DIST

Scale: one chain to an inch.

493

493

XIV/2/25

DEPARTMENT OF LANDS AND SURVEY,
P.O. Box 896,
DUNEDIN.

11-5-51

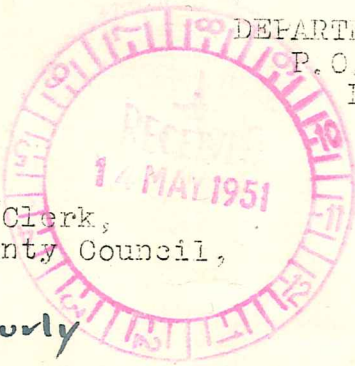

The County Engineer/Clerk,
Maniototo County Council,
Box 47
Ranfurly

Dear Sir,

The Town of Ranfurly Extn. No. 14
Scheme Plan No. 493

I forward herewith Scheme plan of the above subdivision
for your comments in terms of Section 3(4) Land Subdivision in
Counties Act 1946. I propose a building line condition of
.....
Please endorse your comments on the form enclosed herewith.

*The areas concerned are considered to be
commercial allotments.*

Yours faithfully,

H. A. Adams

Chief Surveyor.

7.

See 17/x Ranfurly.

Ref 15/2/51

*Suitable Commercial Allots. 10 2 of 20 plots on
fronting Westland St.*