

MANUHERIKIA RIVER BRIDGE

"Robertson's Crossing"

Sections 52^A on 64 Block IX Leaning Rock S.D.

CONTRACT NO

SHEET NO 1.

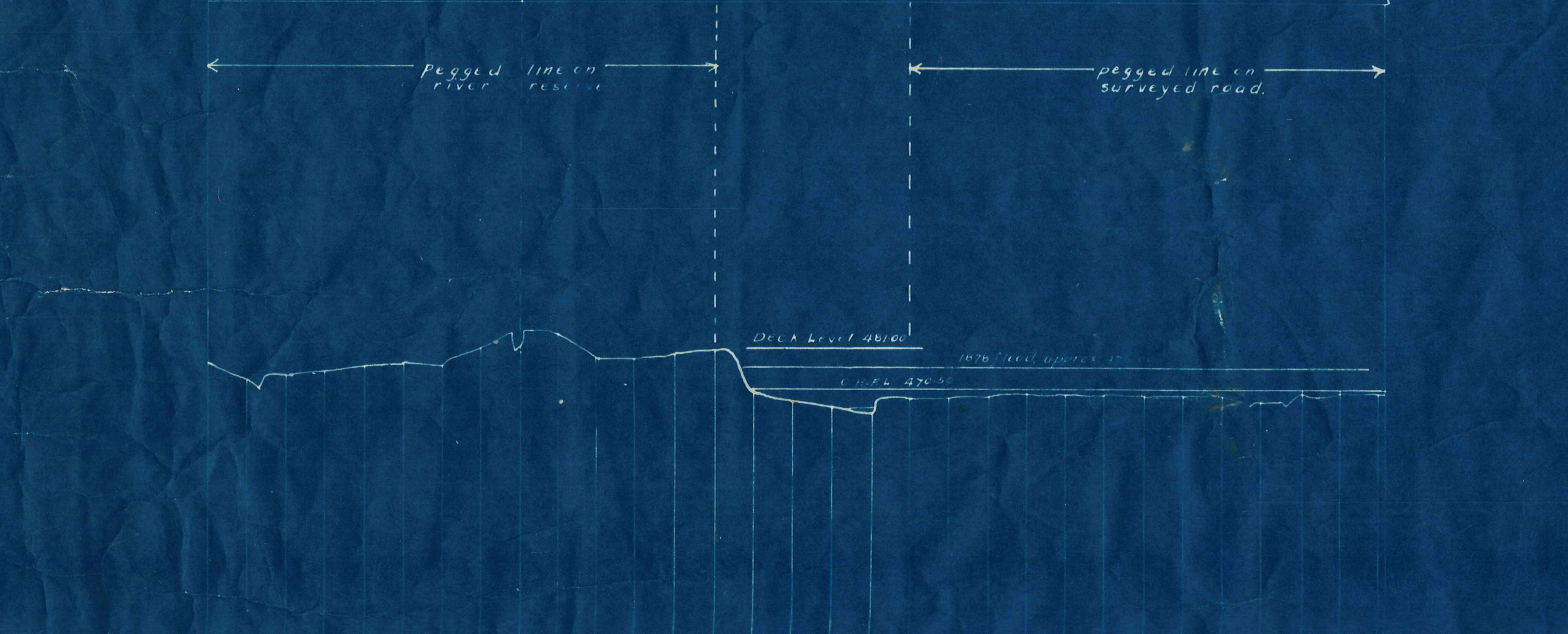
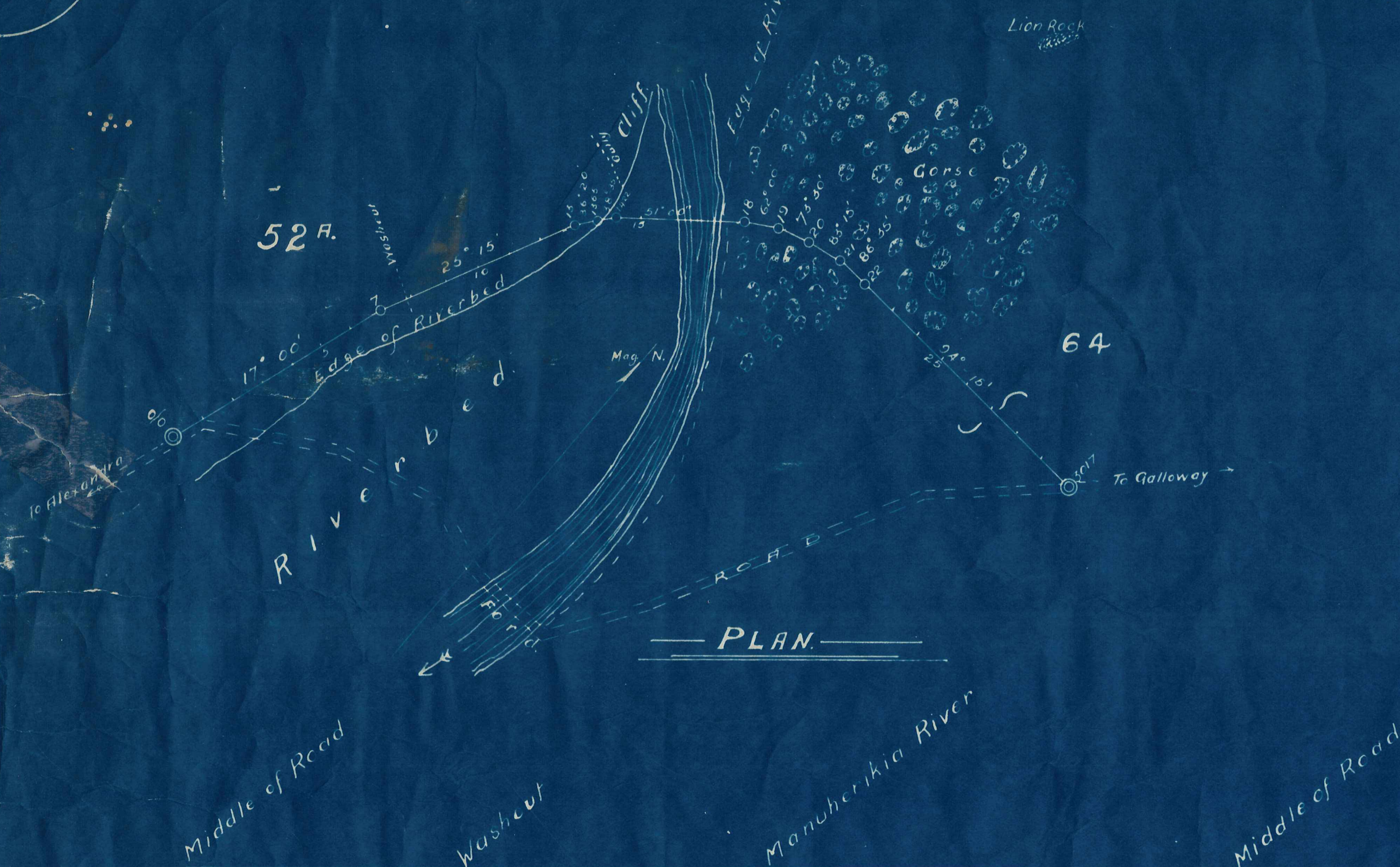

BANKS	HEIGHT ABOVE DATUM 100 FT.															
CUTTINGS	1	2	3	4	5	6	7	8	9	10	11	12	13	14	15	16
FOR LEV.	101.54	101.52	101.50	101.48	101.46	101.44	101.42	101.40	101.38	101.36	101.34	101.32	101.30	101.28	101.26	101.24
RED LEV.	101.54	101.52	101.50	101.48	101.46	101.44	101.42	101.40	101.38	101.36	101.34	101.32	101.30	101.28	101.26	101.24
DISTANCES 0	5	10	15	20	25	30	35	40	45	50	55	60	65	70	75	80

SCALES (HORIZONTAL 3 CHAINS) (VERTICAL 30 FEET) TO 1 INCH

Surveyed by M. J. ROBERTSON, R.E. P.W.D.
1912

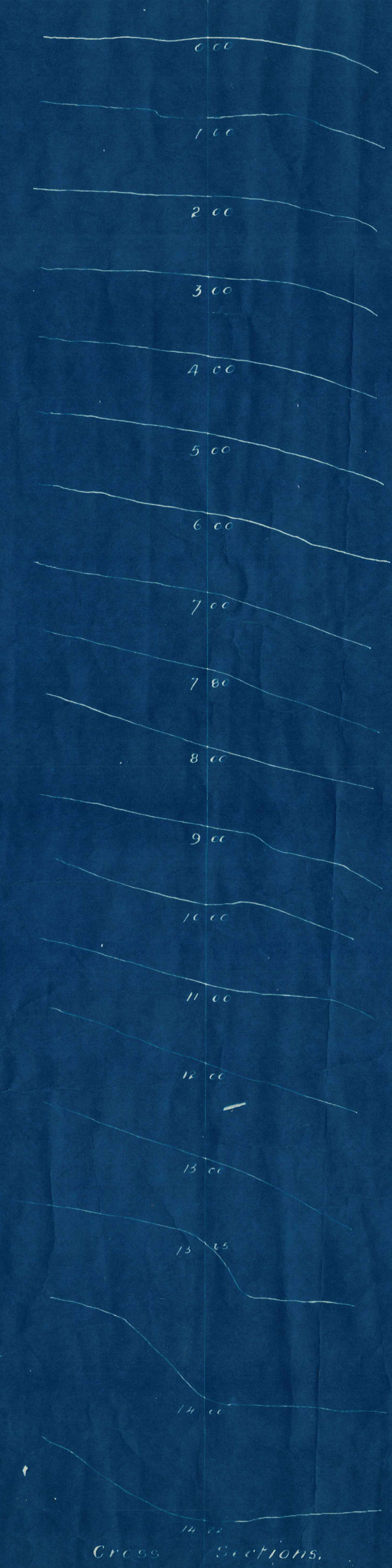

CREW: 2 SECTIONS.
SCALE: 15 FT. 1 INCH.



Locality Plan
Scale: 40 CHAINS 1 INCH

Vincent County Council
11th of August
January 1912

118/7

MANUHERIKIA RIVER BRIDGE

SHEET NO. 2
CONTRACT NO 740

Robertson's Crossing
Sections 32" to 64, Block IX, Leaning Rock SD.

1125ft Spans - 275ft bridge

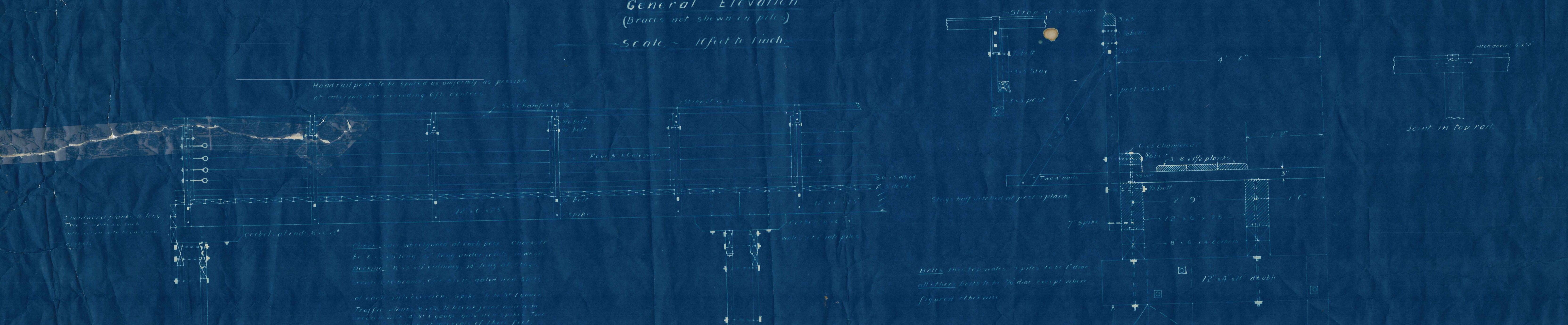
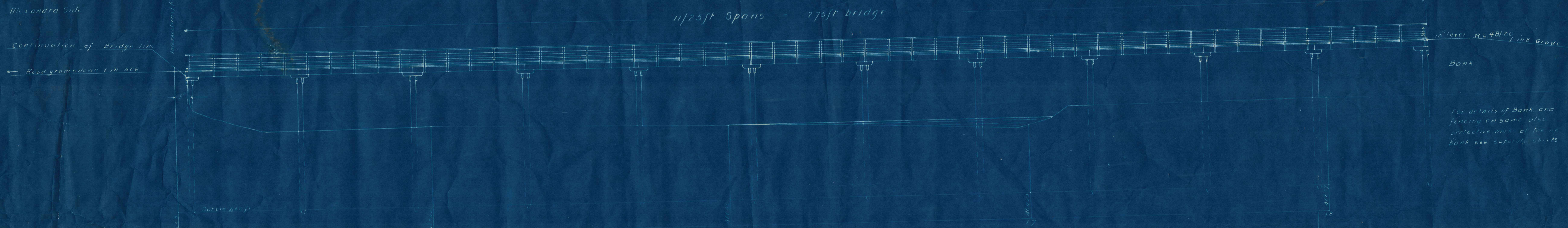

Half Section
Scale - 1/4 inch to 1 foot

Manuherikia County Council
District Engineer

118/1
D.F.