

12th. June,

- 52.

The Secretary,  
R.R.R. Association,  
RANFURLY.

Dear Sir,

PROPOSED DRAINAGE EXTENTION RANFURLY WEST.

Attached please receive plan and original report on above.

A revised estimate, comprising 12 chs. of 6" dia. sewer, and 34 chs. of 9" dia. including two lamp holes and eight manholes and 16 chs. of open cut in sec 11/VI Maniototo amounts to £2648.

The original was to be a request to the Council to construct this section of sewer <sup>would</sup> later form part of the Town Drainage Scheme which has its disposal and treatment point near the junction of Ranfurly - Waipista Road and Barney's Lane close to Hospital Creek, where the effluent from existing sewage is absorbed into the gravel base of the road reserve. When climate obstructed any absorption a channel was cut with consent of the Land Owner to the South East to carry the effluent further.

Owing to domestic <sup>race and</sup> rights to the South it is desirable to have this absorption and underflow as far East as possible. In addition a great future saving is effected by having one disposal or treatment point for the town.

To gain this result in the meantime without the costly disposal plant, it is necessary that all foul sewage be liquified by the use of septic tanks before entering the sewer. This means that every connecting Ratepayer has the additional cost of a septic tank and the short length of 4" dia. drain necessary to reach the sewer.

The construction of the sewer was proposed in the form of an agreement with the Ratepayers concerned that the interest on the total cost be carried as a group and paid annually at Bank Overdraft rate of 4% until such time as the full town scheme is inaugurated.

The planned sewer line allows for considerable depth at Stafford Street enabling the inclusion of any prospective buildings towards Stuart Road.

Yours faithfully,

COUNTY ENGINEER.

RANFURLY WEST DRAINAGE.

MANIOTOTO COUNTY COUNCIL  
30th June, 1950.

Introduction: About the year 1925 the small stream, originating in a spring above Caulfield Street, became a source of annoyance owing to various wastes being allowed to flow into same and, with the gradual growth of buildings, finally created a nuisance about the culvert under the Charlemont Street, W.

In a few years time Mr. Mitchell, builder, erected on request a number of small shops between this point and his shop at the junction with Granville Place: also residences on Railway Land and adjoining the Charlemont St. West culvert - previously referred to - contributed to this pollution. Mr. Mitchell then asked and received permission to pipe this stream as sealed 12" sewer with manholes, from the culvert in Charlemont St. West to a similar culvert near his residence in Granville Place, a distance of 7 chains. At this time there were no buildings in proximity to the stream south of Granville Place, and the open polluted stream carried on from this point for 21 chains to a culvert in Alexander Street approx. 5 chains east of the Roman Catholic Church - thence in open country south.

The area including this last 21 chains is the subject of this report. In the succeeding 25 years, buildings have been erected on all sides and above this stream in the form of 10 dwellings and the Sacred Heart Convent and School. The small creek has now become offensive in warm weather and is difficult to clean as a channel with an average fall of approx. 1 in 110. The upper enclosed section carries the effluent from five septic tanks as well as wastes and the lower section has a few straggling open waste channels feeding in.

Plan: In order to serve the area in permanent levels with final effluent leading to a disposal point near Bandy's Creek, previously decided in a full town scheme and including all present buildings with levels suitable for future buildings it would require 63 chains of 9" dia. sewer with 8 manholes, intake and outlet boxes estimated to cost £2,750 reduced if open cut were allowed south of Alexander Street to £2070 and contingencies £130 making a total of £2,200.

The building owners served are as follows:

- |     |                           |   |                                      |
|-----|---------------------------|---|--------------------------------------|
| 1.  | Marslin                   | ) | Granville Place.                     |
| 2.  | Otago Farmers, J. Crossan | ) |                                      |
| 3.  | C. McCallum               | ) |                                      |
| 4.  | D. Reid                   | ) |                                      |
| 5.  | P. Simmons                | ) | Stafford Street.                     |
| 6.  | J. Scott                  | ) |                                      |
| 7.  | J. Hutcheon               | ) |                                      |
| 8.  | Roman Catholic School &   | ) | Stuart Road.                         |
| 9.  | Convent                   | ) |                                      |
| 10. | J. O'Neill                | ) | Subdivision of Ranfurly Extn. No. 2. |

R. J. BLACK,

*Contact Mr Simmons*

COUNTY ENGINEER.

**LEGEND**

- Creeks and Stormwater Culverts shown
- Existing Sewers, Manholes and Outlet box shown
- Existing Open Cut Drain shown
- Proposed New Sewer in Red.
- " Manholes, Lampholes and outlet box shown
- " New Open Cut Drain shown

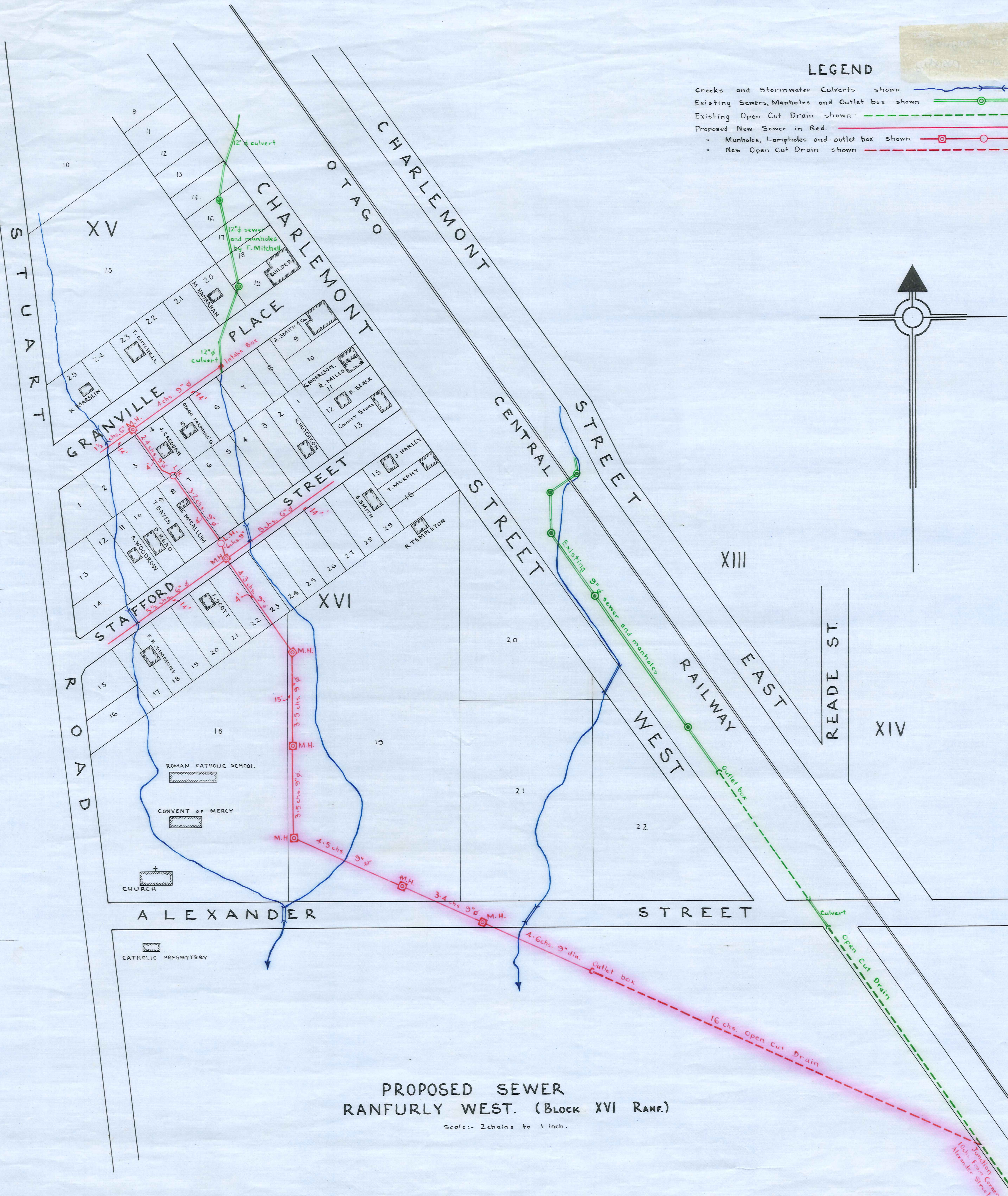
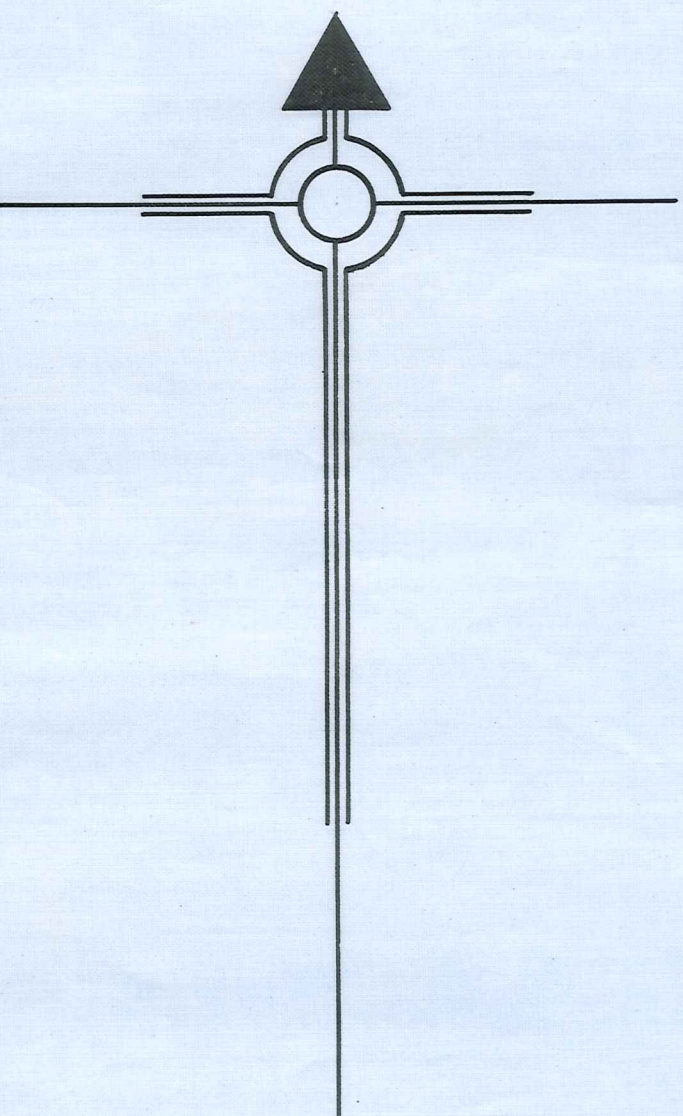

**PROPOSED SEWER  
RANFURLY WEST. (BLOCK XVI RANF.)**

Scale: 2 chains to 1 inch.