

- Valve
- Hydrant
- 6" Red
- 4" Blue
- 3" Green
- 2" Yellow
- 1/2" Brown

Scale: 2 ch to an inch.

MANIOTOTO COUNTY COUNCIL

RANFURLY WATER RETICULATION

DUFFILL, WATTS & KING
 CIVIL ENGINEERS AND SURVEYORS
 DUNEDIN and INVERCARGILL

DATE	NAME	JOB NO.
		2731/7

Then 20 1/2 chns. - 1 1/2" dia. on South side of Golf Road to Sawmill
 Plus 12 1/2 chns. - 2" dia. to Highway Junction

Scale: 2 ch. to an inch.

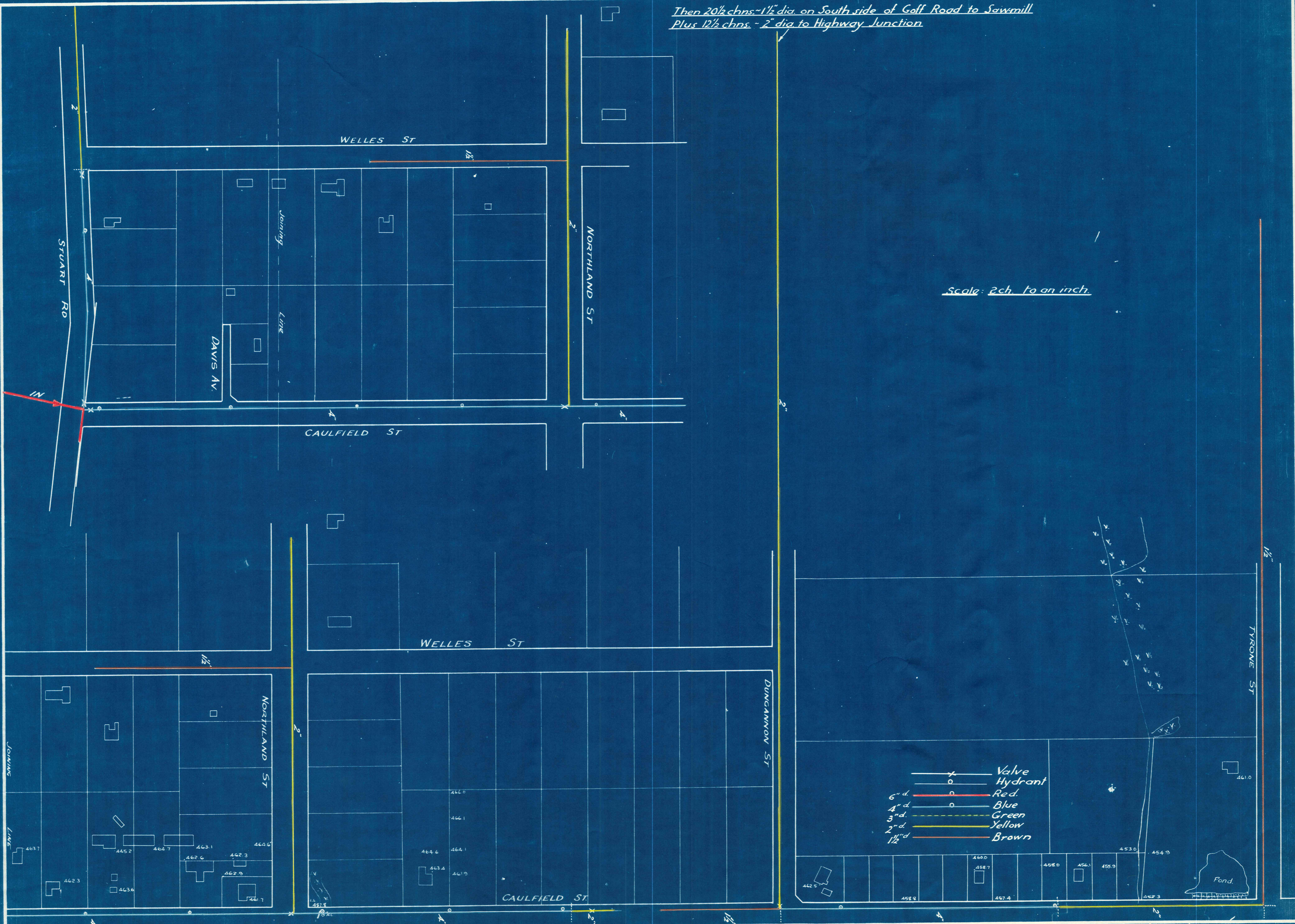

- x — Valve
- o — Hydrant
- 6" d. — Red.
- 4" d. — Blue
- 3" d. — Green
- 2" d. — Yellow
- 1 1/2" d. — Brown

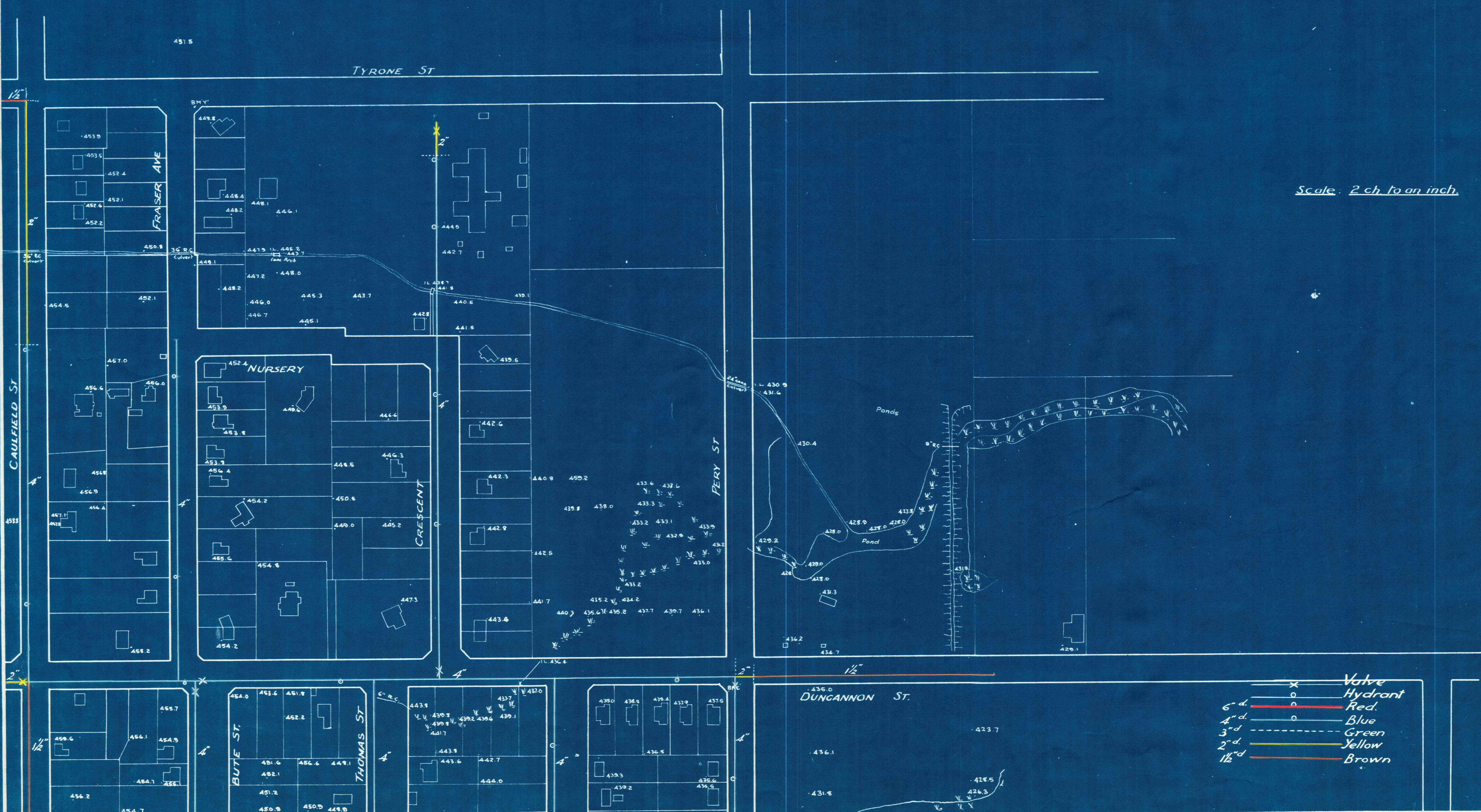

Scale: 2 ch. to an inch.

MANIOTOTO COUNTY COUNCIL

RANFURLY WATER RETICULATION

DUFFILL, WATTS & KING
 CIVIL ENGINEERS AND SURVEYORS
 DUNEDIN and INVERCARGILL

NAME	DATE
SURVEYED BY	
DRAWN	
CHECKED	
FINAL	

JOB NO.
2731/9
 P.B.K. FILE NO.

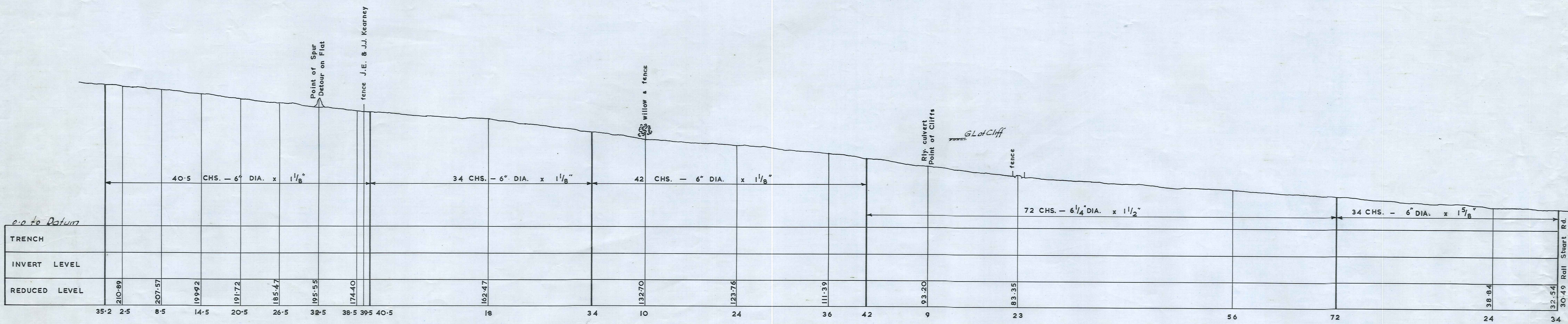
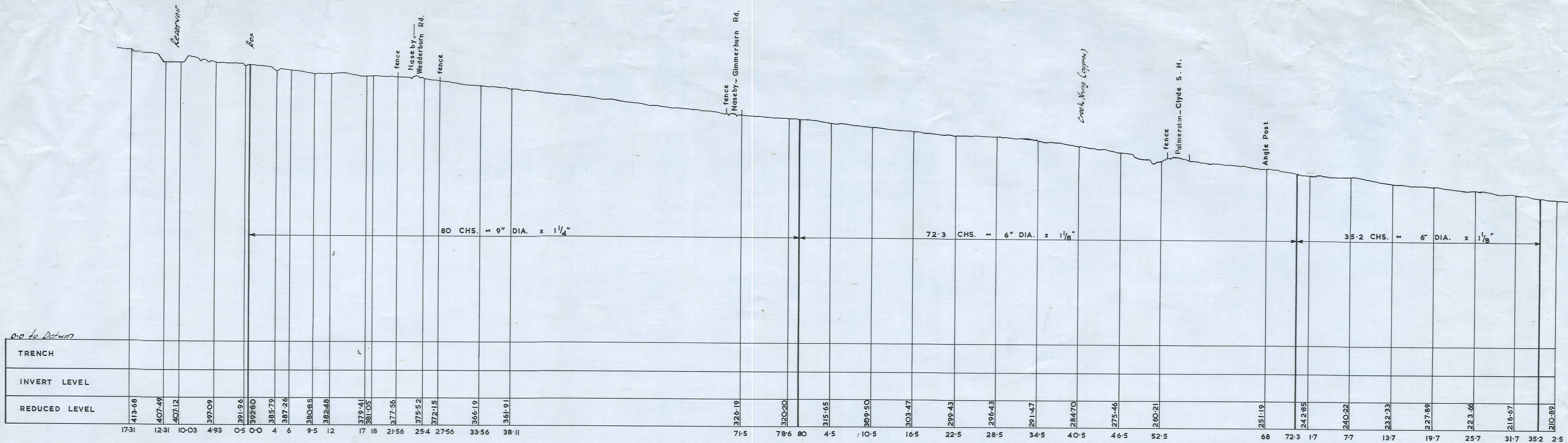

2731/10

MANIOTOTO COUNTY	RANFURLY WATER SUPPLY	SCALES: AS SHOWN
CONTRACT No.	Profile of Gravity Main Reservoir & Feeder Spring	FOLDER: No. 4
		MCC. 235
		SHEET No. 2 OF SHEETS

800 to 100 Horiz. : 80' to 100 Vert.